

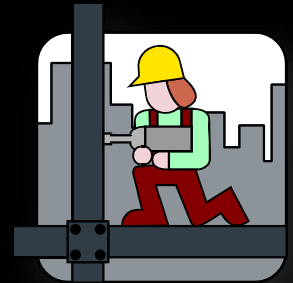

2015 Bond Bradley Middle School Additions and Renovations Project Schematic Design Presentation

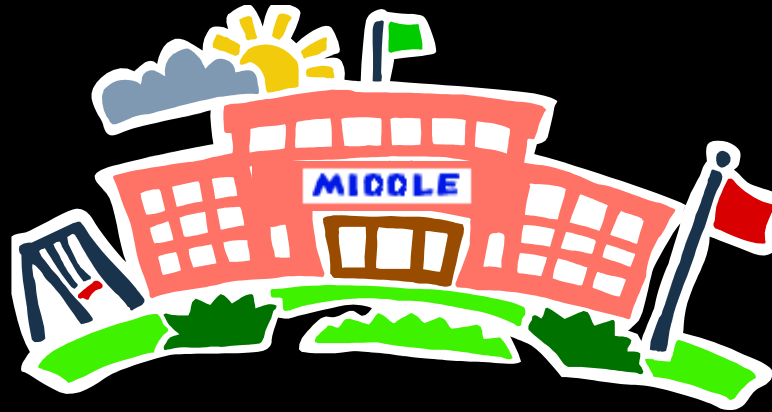

Garrett J. Sullivan, Executive Director
Construction Management and Engineering Department

December 12, 2016

Schematic Design Presentation Agenda

- Project Design Team
- Program Review
- Project Site Analysis
- Concept Design Plans
- Budget Review
- Project Phasing Plan
- Schedule Review
- Staff Recommendation



Bradley Middle School Project Design Team

- Architect: McChesney/Bianco Architecture
- MEP Engineer: MS2 Consulting Engineers
- Structural Engineer: Danysh & Associates
- Civil Engineer: Gonzalez-De La Garza & Associates
- Roofing Engineer: Wiss, Janey, Elstner & Associates
- Technology Engineer: Combs Consulting Group
- Fire Protection/Building Code Engineer: Protection Development, Inc.
- Landscape Architect: Cooper-Lochte Landscape Architecture
- Food Service Engineer: Robert Simpson & Associates
- Acoustical Engineer: Wrightson, Johnson, Haddon, & Williams
- Geotechnical & Material Testing: Professional Services Industries
- Test, Balance, and Commissioning: Energy, Testing, & Balance



Bradley Middle School Site Aerial



Campus Site Aerial

*Bradley Middle School
North East ISD*

2015 Bond Program Review for Bradley Middle School Project #s 1.2, 4.1, 5.8

- Construct Secure Entry Vestibule at Main Front Entrance
- Construct New Fine Arts Facility Addition (2nd Band Hall)
- Renovate Existing Fine Arts Facility (Band Hall Area)
- Expand/Renovate Cafeteria Dining Area and Stage Areas
- Construct New Drama Program Area (Black Box Theater)
- Construct Various Site Improvements (Landscape, Irrigation, Drainage, Site Utilities, and Hardscape)
- Construct Covered Walkway to Access New Fine Arts Facility Addition

2015 Bond Program Review for Bradley MS

1. Secure Entry Vestibule (1,000 sq. ft.)
2. New Fine Arts Addition (5,550 sq. ft.)
 - a. 2nd Band Hall Facility with 5 Wenger Practice Rooms
 - b. Band Office, Music Library, and Instrument Storage Area
3. Fine Arts Facility Renovations (2,500 sq. ft.)
 - a. Existing Band Area (Painting, LED Lighting, Flooring, & Faculty Restroom)
4. Expand/Renovate Cafeteria Dining Area (18,235 sq. ft.)
 - a. Expand Cafeteria Dining Area
 - b. Renovate Existing Cafeteria Area
 - c. Construct New Drama Program Area (Black Box Theater)
 - d. Expand Stage Area
 - e. Boys' and Girls' Restrooms
5. Various Site Improvements
 - a. Landscape, Irrigation, Drainage, Site Utilities, and Hardscape
6. Covered Walkway to Access Fine Arts Addition (Bid Alternate: Enclose Corridor)

Facility Additions = 19,345 sq. ft.
Facility Renovations = 7,940 sq. ft.

Bradley MS Project Site Analysis (Facility Additions/Renovations)

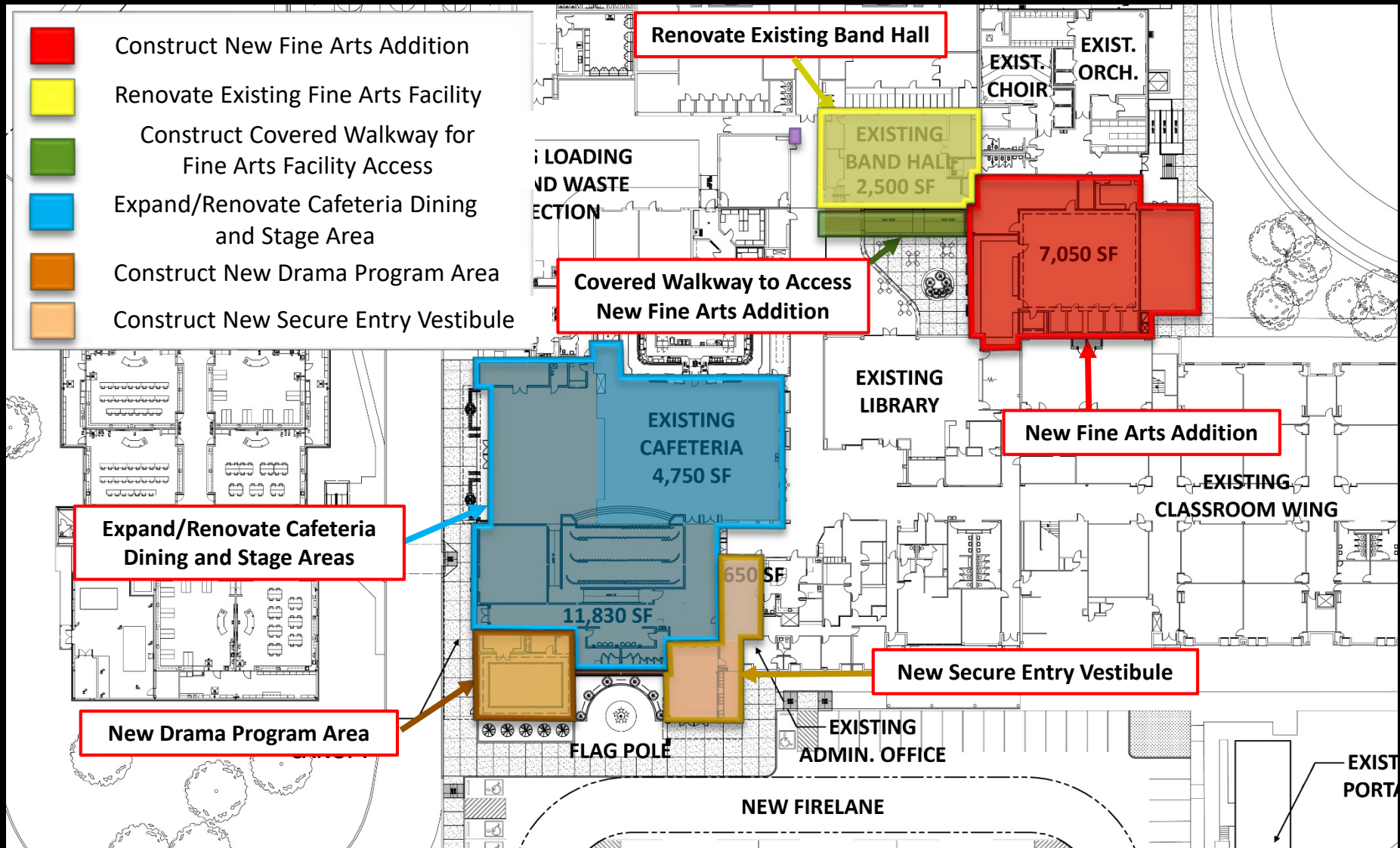

Bradley MS Cafeteria Expansion/Renovation Floor Plan

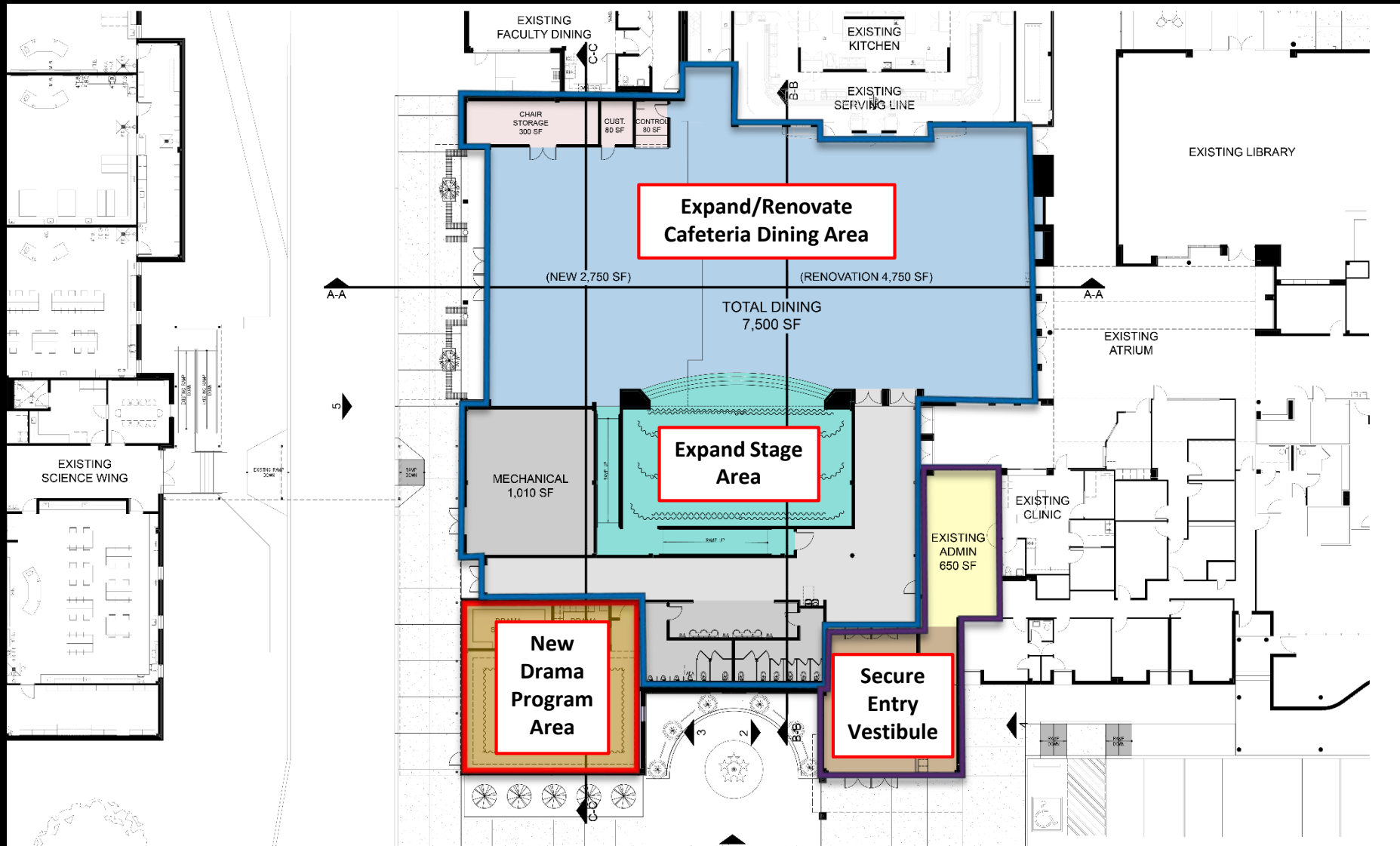

Cafeteria Expansion/Renovation Floor Plan

Bradley Middle School
North East ISD

Bradley MS Fine Arts Facility Addition Floor Plan

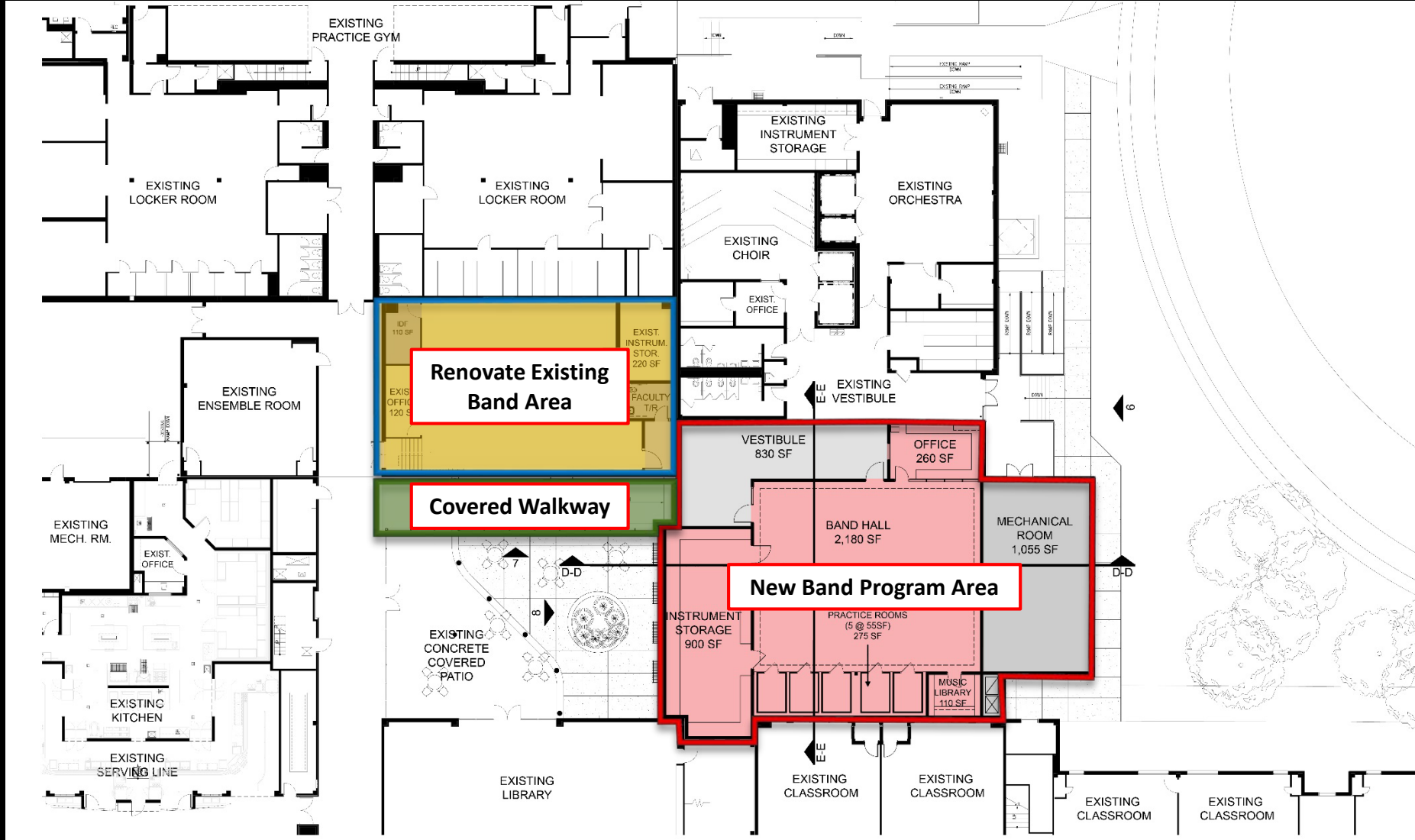

Fine Arts Facility Addition Floor Plan

Bradley Middle School
North East ISD

Bradley MS Cafeteria Expansion Facility Perspective

**View of Cafeteria Expansion Looking Northeast
from Bus Loading/Unloading Area**



Bradley MS Cafeteria Expansion Perspective

*Bradley Middle School
North East ISD*

Bradley MS Facility Addition Perspective

View of New Addition Looking West from Front Parking Lot



Bradley MS Facility Addition Perspective

*Bradley Middle School
North East ISD*

Bradley MS Facility Addition Perspective

View of New Addition Looking West from Front Parking Lot



Bradley MS Facility Addition Perspective

*Bradley Middle School
North East ISD*

Bradley MS Fine Arts Addition Facility Perspective



Bradley MS Fine Arts Addition Facility Perspective

*Bradley Middle School
North East ISD*

Budget Review for Bradley MS Project

• Design Account:	\$ 1,750,000
• Construction Account:	\$ 8,750,000
• Technology Account:	\$ 50,000
• FF&E Account:	<u>\$ 150,000</u>
TOTAL BOND PROGRAM =	\$ 10,700,000

Bradley Middle School Project Phasing Plan – Phase 1

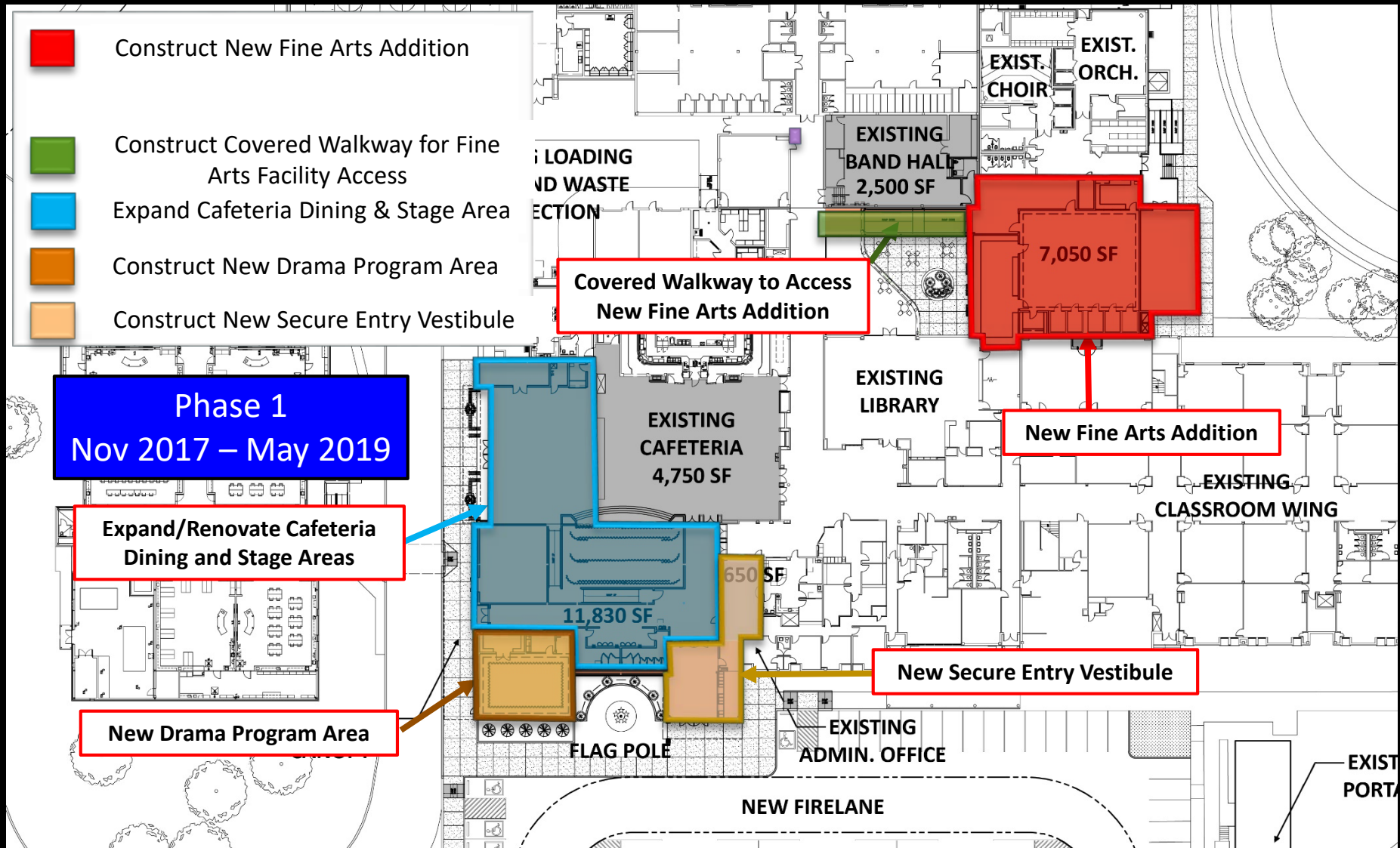

Bradley Middle School Project Phasing Plan – Phase 2

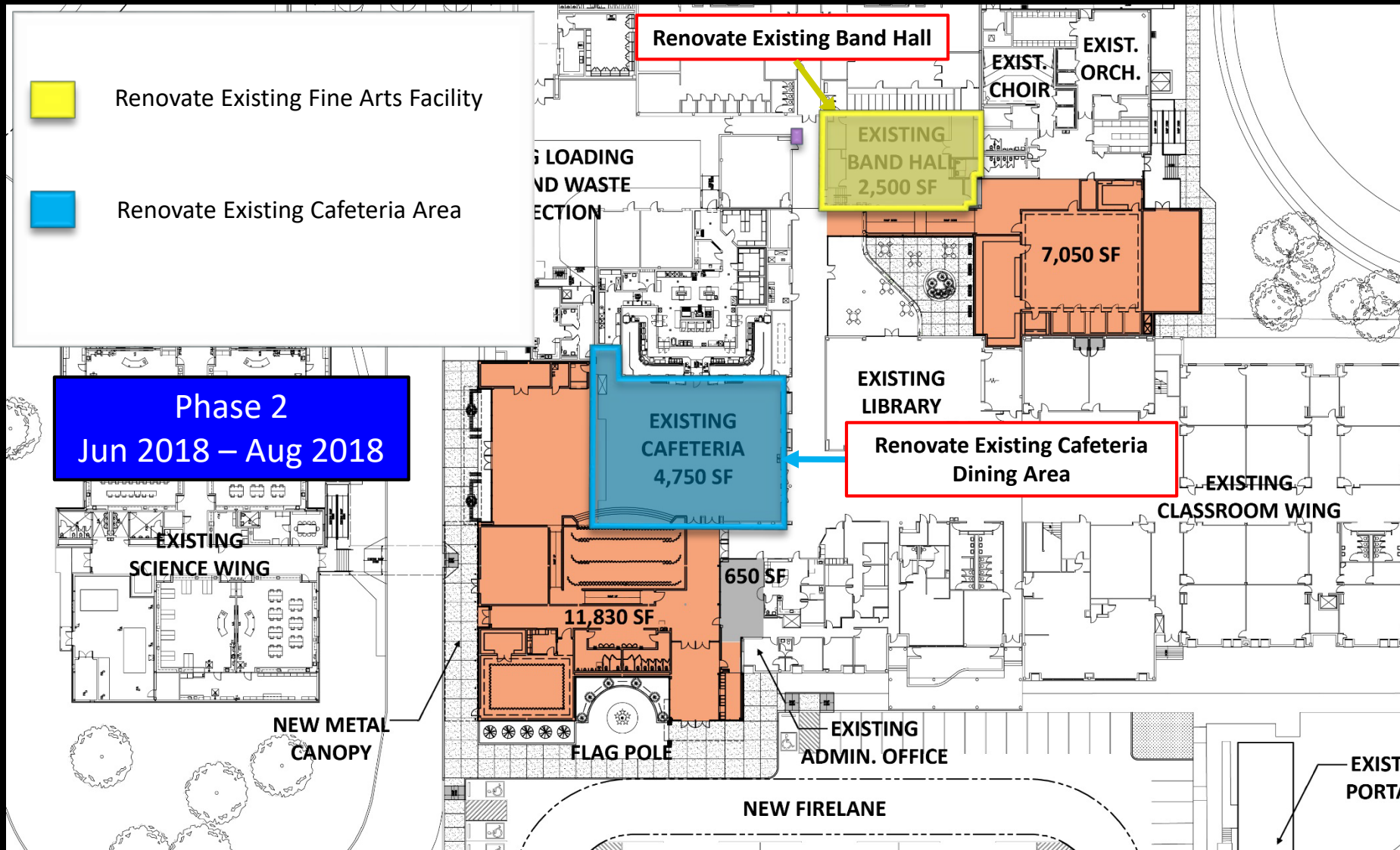

Design & Construction Timeline

12 MONTHS (AUG 2016 – JUL 2017)

PROJECT DESIGN

JUL 2017

3 MONTHS

BID AWD PCS

OCT 2017

18 MONTHS (NOV 2017 – APR 2019)

APR 2019

PHASE 1: FACILITY ADDITIONS

Construct New Fine Arts Facility Addition
and Covered Walkway Connection,
Expand Cafeteria Dining and Stage Area,
Construct New Drama Program Area,
Construct New Secure Entry Vestibule,
Construct Site Infrastructure

PHASE 2: RENOVATIONS

Renovate Existing Band Facility and
Renovate Existing Cafeteria Dining Area

Bradley Middle School 2015 Bond Project

District Staff Recommendation

- Recommend Approval of Bradley Middle School Schematic Design Presentation which Constructs the following 2015 Bond-Approved Program Elements:
 - Construct New Secure Entry Vestibule
 - Construct New Fine Arts Facility Addition (2nd Band Hall)
 - Renovate Existing Fine Arts Facility (Band Hall)
 - Expand/Renovate Cafeteria Dining and Stage Areas
 - Construct New Drama Program Area (Black Box Theater)
 - Construct Various Site Improvements (Landscape, Irrigation, Drainage, Site Utilities, and Hardscape)
 - Construct Covered Walkway to Access New Fine Arts Facility Addition (Include a Bid Alternate to Construct an Enclosed Connecting Corridor)
 - Construction Budget = \$ 8,750,000



2015 Bond Bradley Middle School Additions and Renovations Schematic Design Presentation

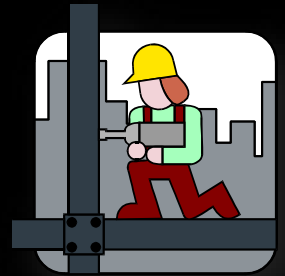
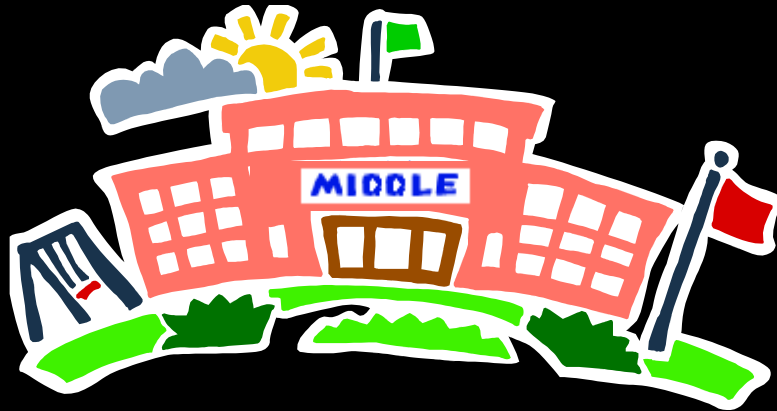

Questions ?