

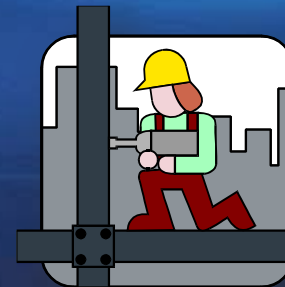

# Churchill High School Schematic Design Presentation 2011 Bond Program



Garrett J. Sullivan, Executive Director  
Construction Management and Engineering Department

**November 12, 2012**

# Schematic Design Presentation Agenda

---



- Project Design Team
- General Site Analysis
- Program Review
- Schematic Design (SD) Plan – Review Final SD Concept & Floor Plan
- Building Exterior – Review Perspectives
- Program Analysis and Budget Review
- CBAC Review
- Project Schedule Review

# Churchill High School Project Design Team

---

- Architect: Rehler Vaughn and Koone (RVK) Architects
- MEP Engineer: MEP Engineers, Inc.
- Structural Engineer: Unitech Consulting Engineers
- Civil Engineer: MTR Engineers, LLC
- Fire Protection Engineer: Protection Development, Inc.
- Landscape Architect: RVK Architects
- Roofing Engineer: Wiss Janney Elstner & Associates
- Technology Consultant: Combs Consulting Group
- Geotechnical & Material Testing: Fugro Consultants, Inc.
- Test, Balance & Commissioning: Testing Specialties, Inc.
- Code Consultant: RVK Architects
- Acoustical Engineer: Dickensheets Design Associates



# Churchill High School Existing Site Aerial



Site Aerial – Existing Campus

Churchill High School  
North East ISD



# Churchill High School Existing Site Aerial

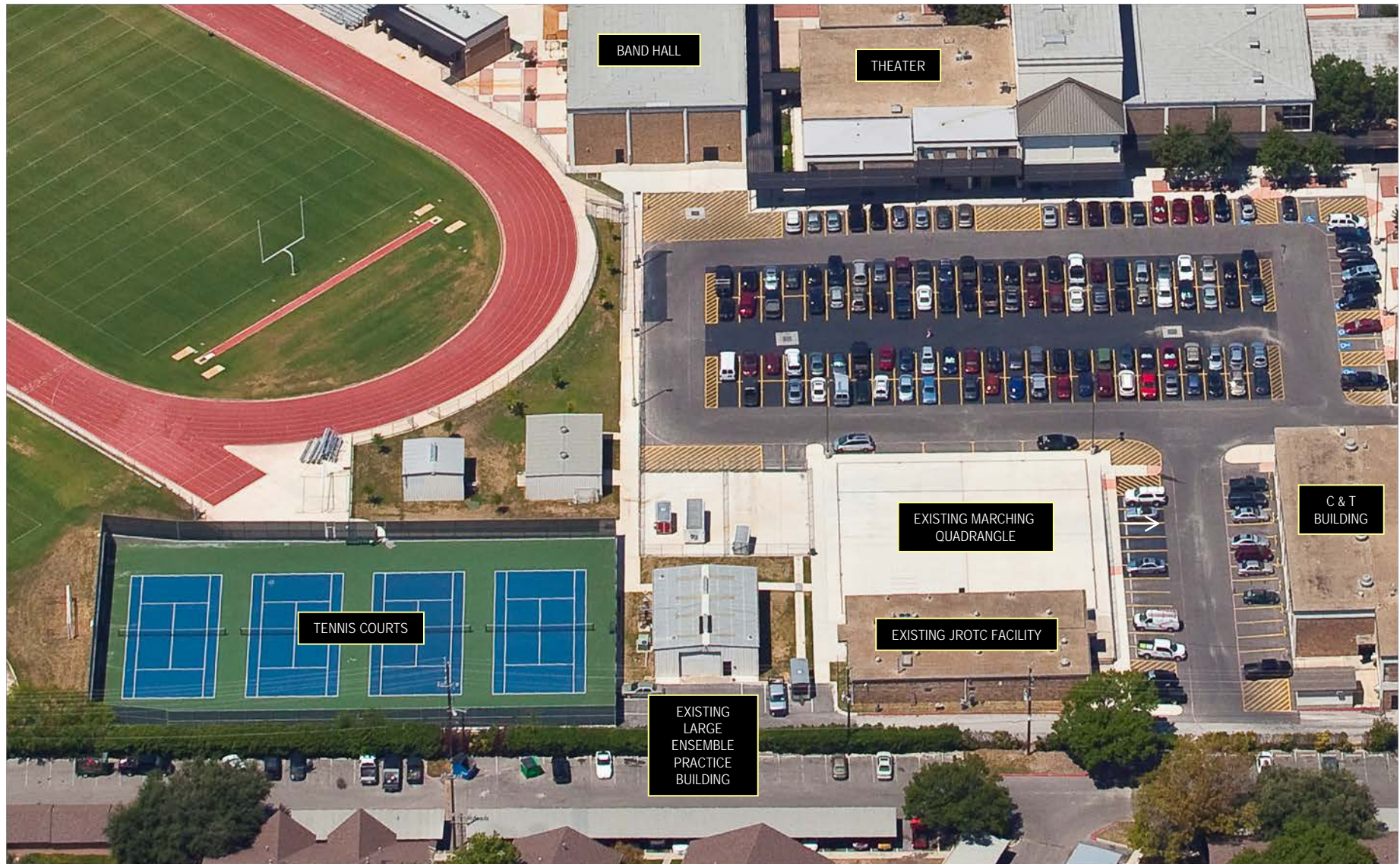

Site Aerial – Existing Campus

Churchill High School  
North East ISD

# Churchill High School Design Program Summary

---

1. **New JROTC Facility (Program @ 12,700 sq.ft.):**
  - a. **Administrative Offices and Workroom for SAI, AI, and Student Cadre**
  - b. **2 Classrooms**
  - c. **8-Lane Rifle Range with Observation Area**
  - d. **Arms Room and Supply Room**
  - e. **Student Locker Rooms and Laundry Support Room**
  - f. **MEP Support Areas**
  - g. **Marching Quadrangle (110 ft x 110 ft)**
2. **New Large-Ensemble Room (Program @ 3,000 sq.ft.)**
  - a. **Large-Ensemble Room (Component of the Fine Arts Program)**
  - b. **Replace Metal Practice Building in Footprint of New Tennis Courts**
3. **2 New Tennis Courts and Tennis Storage Building (10 x 15 sq. ft.)**
4. **Demolition: JROTC Facility and Large-Ensemble Metal Practice Building**

# Churchill High School Program Review



I. JROTC FACILITY						
A.	General Classroom Instructional Program			Number	Sq. Ft.	Total Sq.Ft.
	1.	JROTC Classrooms		2	800	1,600
	General Classroom Instructional Program Subtotal (sq.ft.) =			2 Classrooms		1,600
B.	JROTC Rifle Range			Number	Sq. Ft.	Total Sq.Ft.
	1.	Rifle Range (8 Lanes) 36 ft x 50 ft		1	1,800	1,800
	2.	Rifle Range Observation Area (25 ft x 36 ft)		1	900	900
	JROTC Rifle Range Program Subtotal (sq.ft.) =			8 Lane Rifle Range		2,700
C.	JROTC Support Areas			Number	Sq. Ft.	Total Sq.Ft.
	1.	Arms Room Storage Area (Weapons)		1	125	125
	2.	Arms Room Storage Area (Drill and Ceremony)		1	200	200
	3.	Supply Room - Equipment		1	810	810
	4.	Supply Room - Paper Products		1	40	40
	5.	Laundry Room (2 Washers and 2 Dryers) 16 ft x 13 ft		1	208	208
	6.	Ice Machine Room (10 ft x 11 ft)		1	110	110
	JROTC Support Areas Program Subtotal (sq.ft.) =			Support Areas		1,493
D.	JROTC Cadre Office Areas			Number	Sq. Ft.	Total Sq.Ft.
	1.	SAI Office		1	225	225
	2.	AAI Office		1	215	215
	3.	Cadet Staff Office and Conference Area		1	825	825
	4.	Cadet Staff Work Room		1	400	400
	5.	Staff Restroom		1	130	130
	JROTC Cadre Office Areas Program Subtotal (sq.ft.) =			Cadre Office Areas		1,795
E.	JROTC Locker Room and Dressing Support Areas			Number	Sq. Ft.	Total Sq.Ft.
	1.	Boys' Locker Room, Dressing, Shower, and Restroom Area		1	700	700
	2.	Girls' Locker Room, Dressing, Shower, and Restroom Area		1	700	700
	JROTC Locker Room and Dressing Support Areas Program Subtotal (sq.ft.) =			Locker Room Areas		1,400

# Churchill High School Program Review



F. MEP and Technology Support Areas		Number	Sq. Ft.	Total Sq.Ft.
1.	Mechanical / Electrical Room	1	520	520
2.	Custodial Wet Closet	1	40	40
3.	Sprinkler Riser Room	1	60	60
4.	IDF Room	1	50	50
MEP and Technology Support Areas Program Subtotal (sq.ft.) =		MEP & Tech Support Areas		670
G. Facility Net to Gross		Number	Sq. Ft.	Total Sq.Ft.
1.	Net -to-Gross Area (Includes Corridors, Circulation Space, and Wall Thicknesses)	1	3,042	3,042
Facility Net to Gross Program Subtotal (sq.ft.) =		Net to Gross Area		3,042
H. JROTC Marching Quadrangle		Number	Sq. Ft.	Total Sq.Ft.
1.	Construct JROTC Marching Quadrangle (110 ft x 110 ft)	1	12,100	12,100
JROTC Marching Quadrangle Program Subtotal (sq.ft.) =		Marching Quadrangle		
TOTAL JROTC FACILITY PROGRAM		2 CLRMs & Rifle Range		12,700
II. TENNIS COURTS UPGRADES		Number	Sq. Ft.	Total Sq.Ft.
1.	Add 2 Tennis Courts (100 ft x 120 ft) to existing Tennis Courts Area	1	12,000	12,000
2.	Outdoor Storage Building (10 ft x 15 ft)	1	150	150
TOTAL TENNIS COURTS UPGRADES PROGRAM				12,150
III. FINE ARTS LARGE-ENSEMBLE FACILITY				
1.	Large-Ensemble Room (39 ft x 48 ft)	1	1,872	1,872
2.	Office (8 ft x 12 ft)	1	96	96
3.	Storage Room (8 ft x 9 ft)	1	72	72
4.	Net-to-Gross Area (Includes Corridors, Circulation Space, and Wall Thicknesses)	1	960	960
Fine Arts Large-Ensemble Program Subtotal (sq.ft.) =		Large Ensemble Room		3,000
TOTAL FINE ARTS LARGE-ENSEMBLE PROGRAM				3,000
IV. CAMPUS DEMOLITION				
1.	Demolish Existing JROTC Facility	1	7,500	7,500
2.	Demolish Existing Metal Building (Large-Ensemble Practice Facility)	1	2,000	2,000
Fine Arts Large Ensemble Program Subtotal (sq.ft.) =		Demolition		9,500
TOTAL CAMPUS DEMOLITION PROGRAM				9,500



# Churchill High School Schematic Design Site Plan

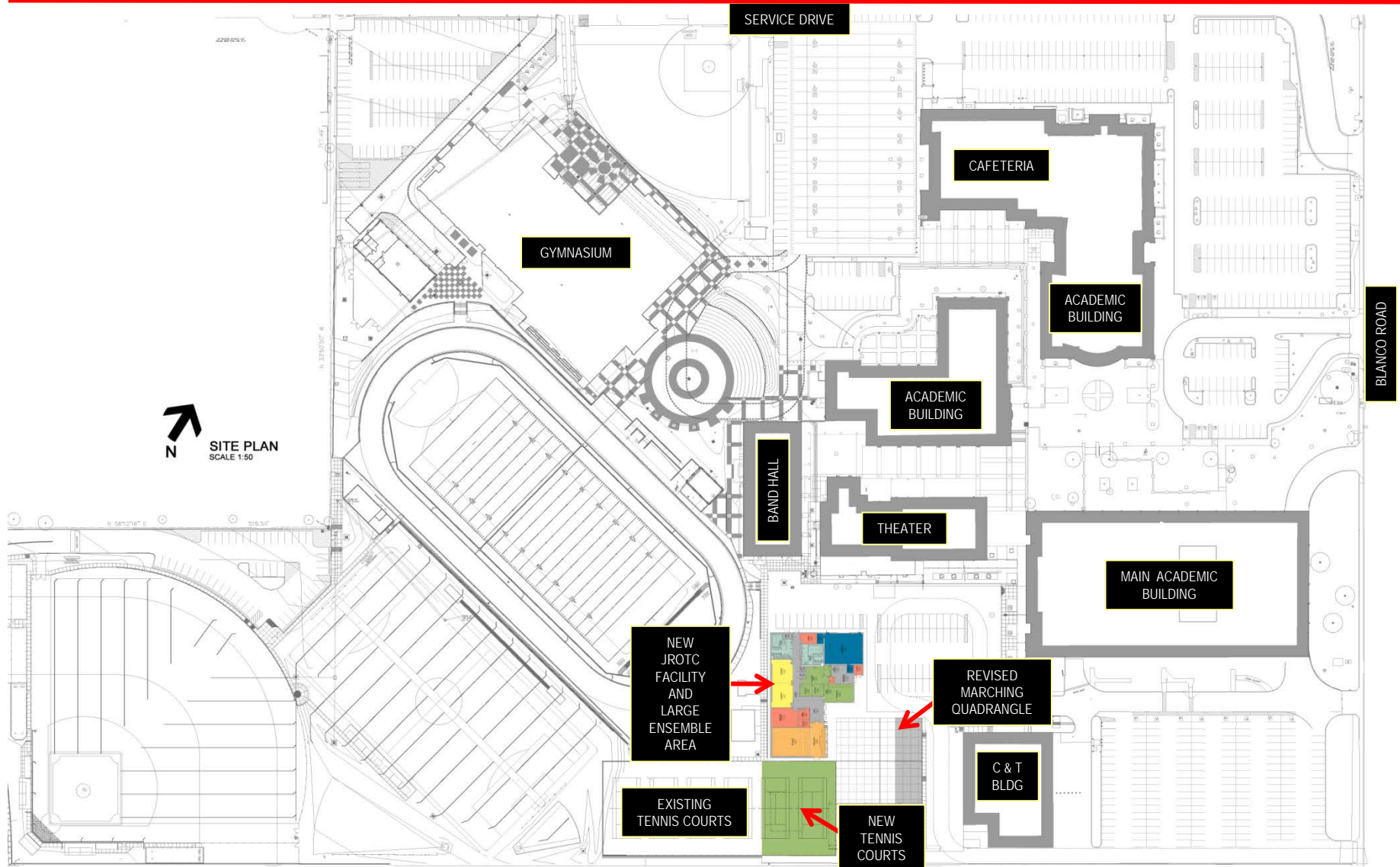

Churchill HS Schematic Design Site Plan

Churchill High School  
North East ISD

# Churchill High School Schematic Design Site Plan

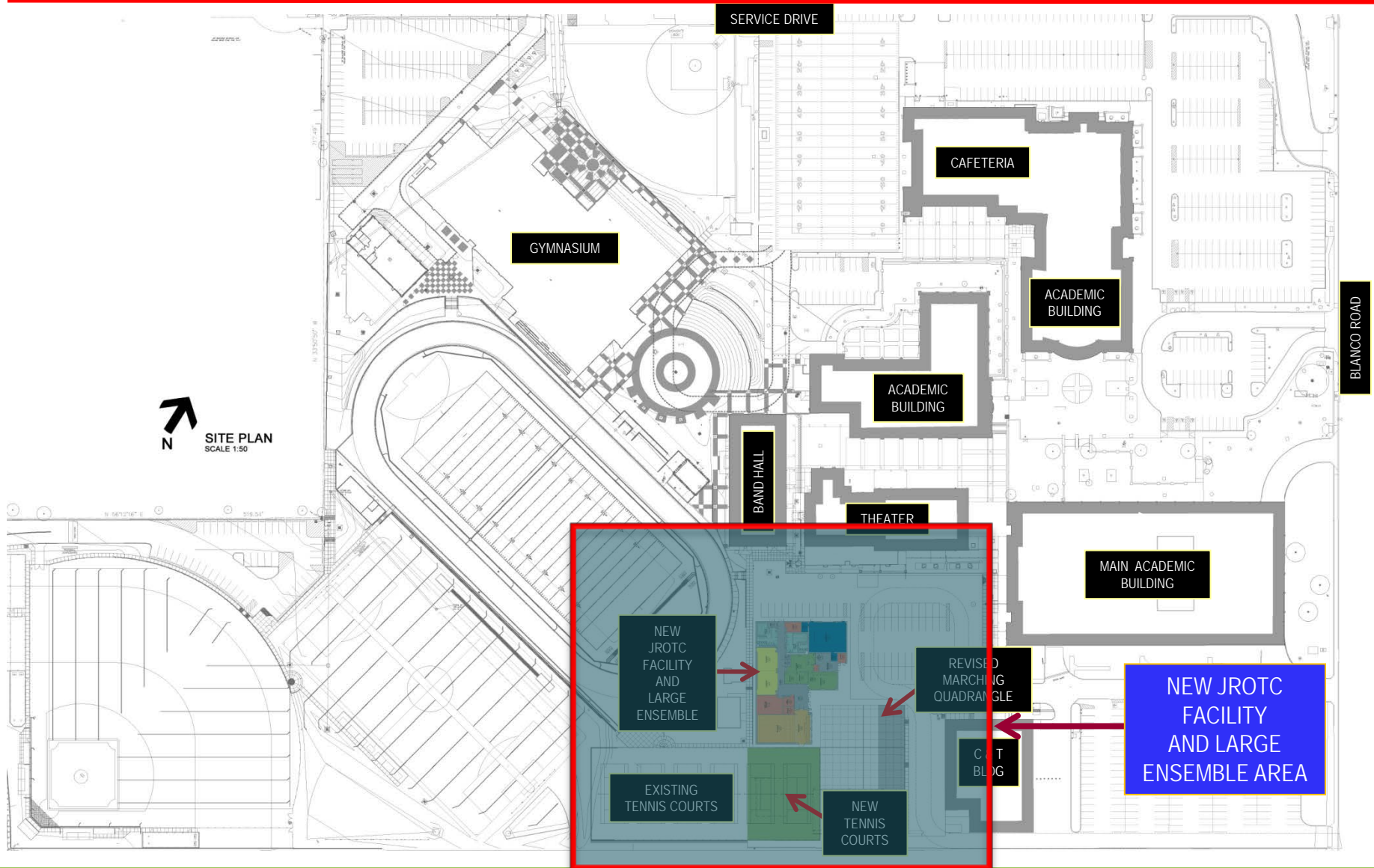

Churchill HS Schematic Design Site Plan

Churchill High School  
North East ISD

# Churchill High School Schematic Design Site Plan

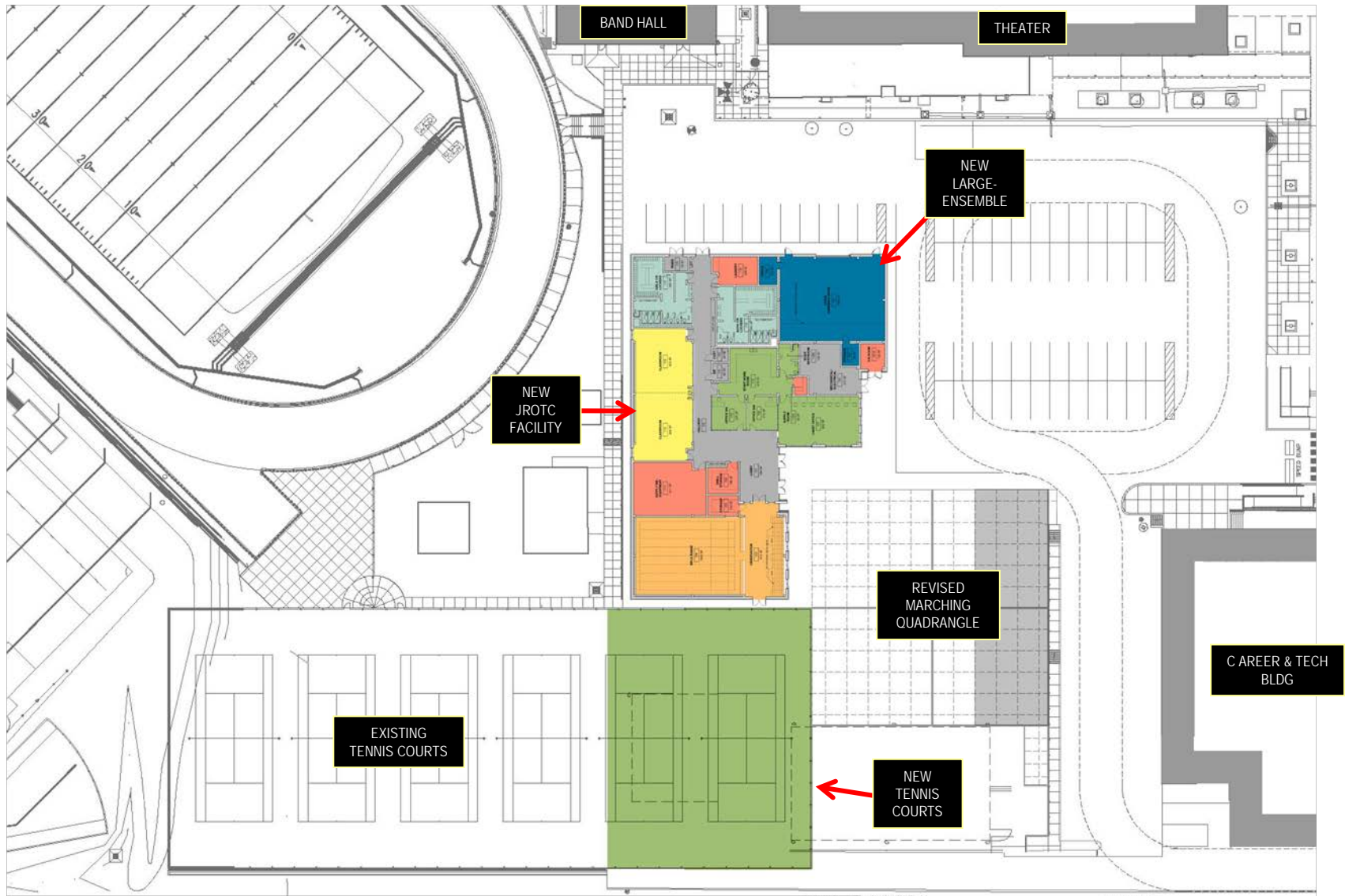

Churchill HS Schematic Design Site Plan

Churchill High School  
North East ISD



# Churchill High School Schematic Design Site Plan

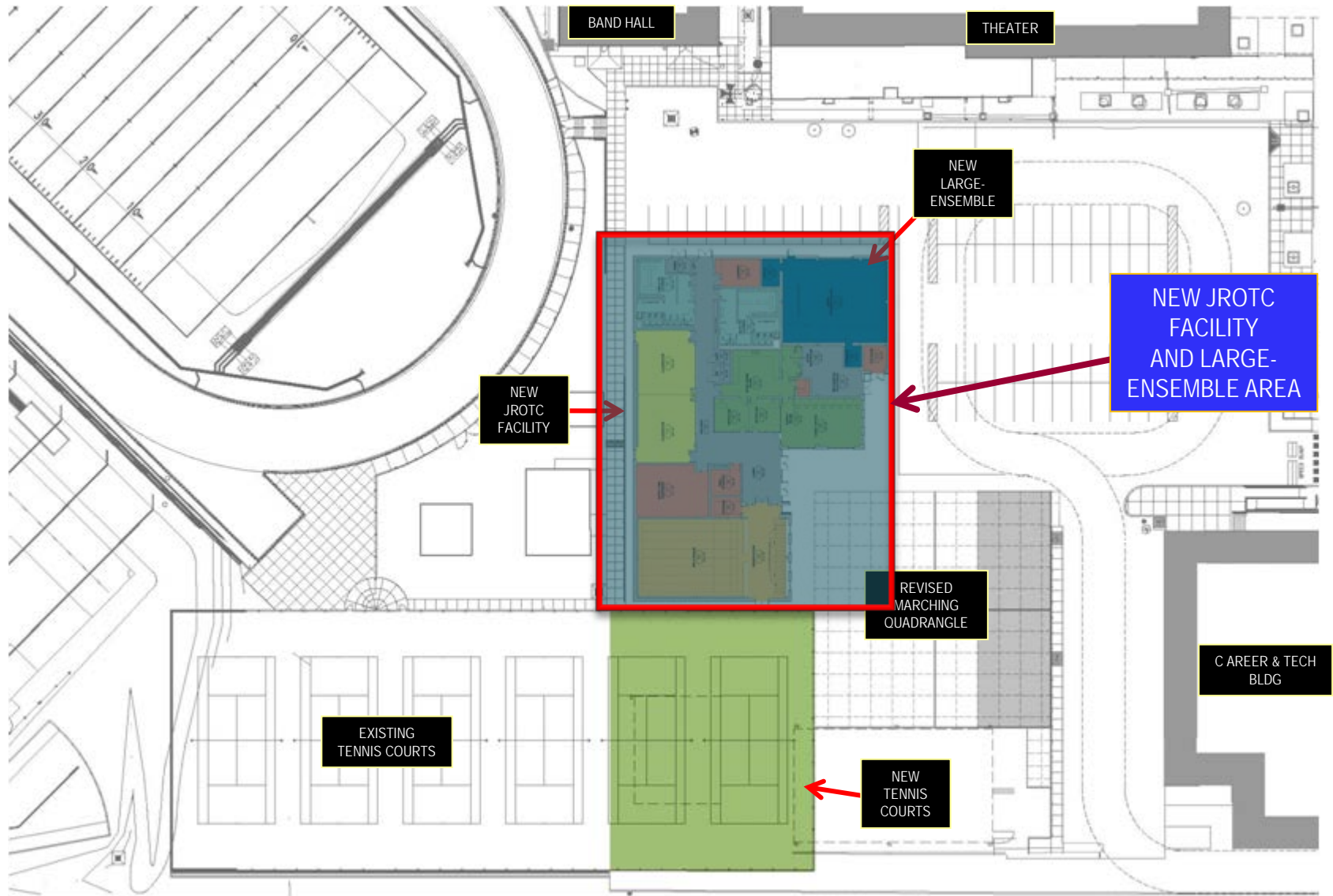

# Churchill High School JROTC Facility Front Perspective

---



Perspective Rendering

*Churchill High School  
North East ISD*

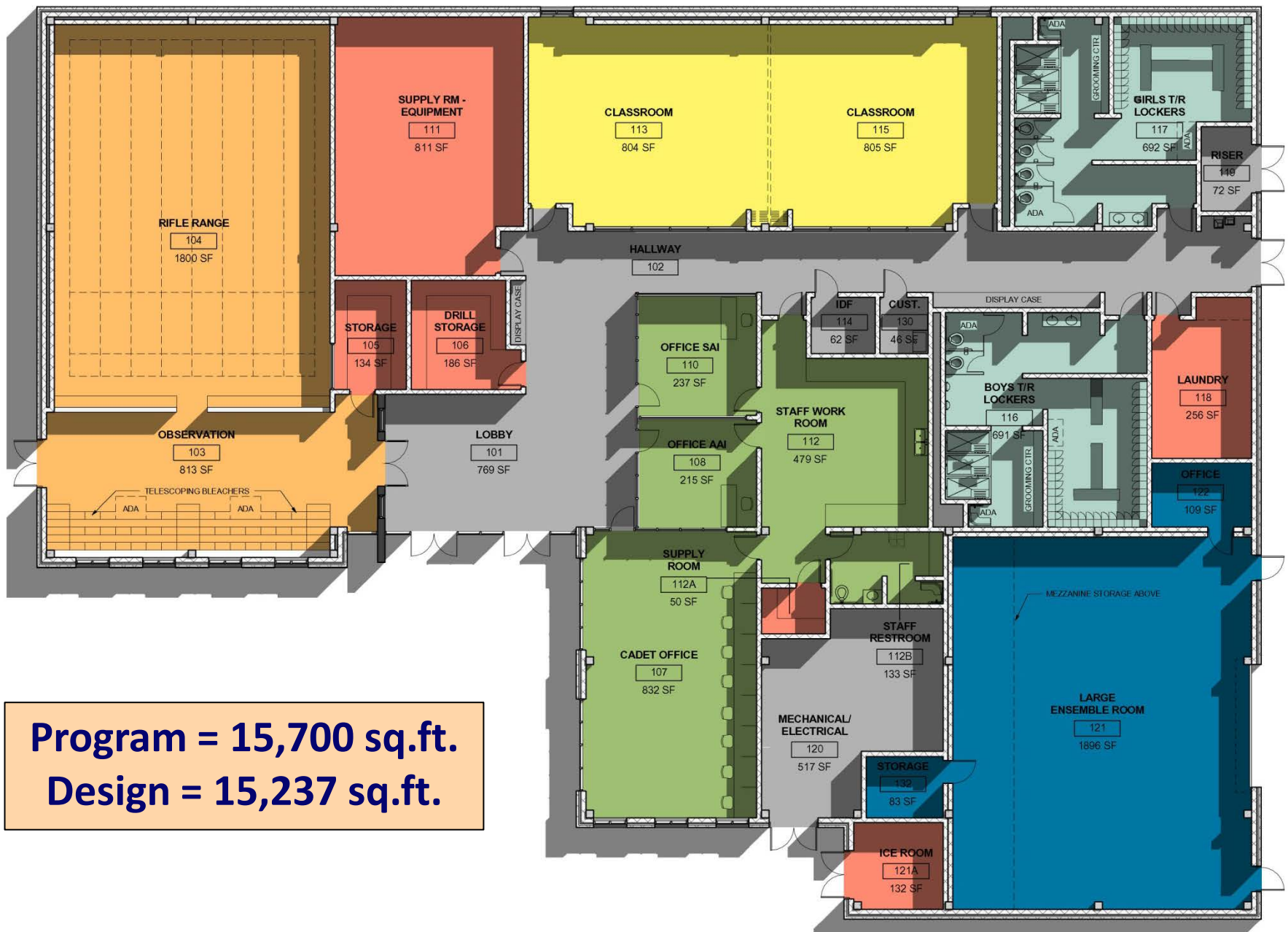



# Churchill High School JROTC Facility Front Perspective



Perspective Rendering

*Churchill High School  
North East ISD*

# Churchill High School Program Analysis

Program Element	Churchill Program	Churchill Design
<b>New JROTC Facility and Large Ensemble Fine Arts Practice Area Project</b>		
JROTC Cadre Office Areas and Workroom	1,795	1,896
JROTC Classrooms	1,600	1,609
8-Lane Rifle Range and Observation Area	2,700	2,613
Arms Room, Supply Room and Ice Machine Room Areas	1,285	1,313
Student Locker Rooms, and Laundry Support Area	1,608	1,639
Large-Ensemble Practice Room , Office, and Storage Areas	2,040	2,088
<b>General Instructional Program Subtotal (sq ft) =</b>	<b>11,028</b>	<b>11,158</b>
MEP Support Areas	670	697
Corridors, Stair Towers, Circulation Space and Walls (Net-to-Gross)	4,002	3,382
<b>Support Program Areas Subtotal (sq ft) =</b>	<b>4,672</b>	<b>4,079</b>
<b>Total Program New JROTC and Large Ensemble Facility Addition (sq ft) =</b>	<b>15,700</b>	<b>15,237</b>
JROTC Marching Quadrangle Area (110 ft x 110 ft)	12,100	12,100
<b>2 New Tennis Courts</b>		
<b>Construct 2 New Tennis Courts</b>	12,000	12,000
<b>Tennis Equipment Storage Building</b>	150	150
<b>Campus Selective Demolition Project</b>		
<b>Demolish Existing JROTC Facility</b>	7,500	7,500
<b>Demolish Existing Large Ensemble Metal Building Practice Facility</b>	2,000	2,000
<b>Total Selective Demolition Program Subtotal (sq ft) =</b>	<b>9,500</b>	<b>9,500</b>

# Churchill High School Budget Review

---

- Design Account: \$ 800,000
- Construction Account: \$ 5,000,000
- Technology Account: \$ 40,000
- Furniture, Fixtures, and Equipment Account: \$ 160,000
- Program Contingency: \$ 250,000
- TOTAL PROGRAM = \$ 6,250,000

Current Schematic Design Construction Estimate = \$4,350,000



# Churchill High School CBAC Review

## 2011 Bond Planning Estimate

Board Approved Budget = \$ 5,000,000

### Project Scope

- New JROTC Facility including:
- Cadre Office Areas and Workroom
- 2 Classrooms
- 8-Lane Rifle Range and Observation Area
- Arms Room, Supply Room, & Ice Room
- Student Locker Rooms and Laundry Support Area
- JROTC Marching Quadrangle
- Fine Arts Large Ensemble Practice Room
- Building Size @ 15,700 sq.ft.
- 2 New Tennis Courts & Storage Building
- Campus Selective Demolition Project
- Demolish Existing JROTC Facility
- Demolish Existing Large Ensemble Metal Building Practice Facility
- Demolition Area @ 9,500 sq.ft.

### Timeline

- New JROTC Facility Opens Jul 2015

## 2011 Bond Program Execution

☑ Construction Cost Estimate = \$ 4,350,000

### ☑ Project Scope

- New JROTC Facility including:
- Cadre Office Areas and Workroom
- 2 Classrooms
- 8-Lane Rifle Range and Observation Area
- Arms Room, Supply Room, & Ice Room
- Student Locker Rooms and Laundry Support Area
- JROTC Marching Quadrangle
- Fine Arts Large Ensemble Practice Room
- Building Size @ 15,237 sq.ft.
- 2 New Tennis Courts and Storage Building
- Campus Selective Demolition Project
- Demolish Existing JROTC Facility
- Demolish Existing Large Ensemble Metal Building Practice Facility
- Demolition Area @ 9,500 sq.ft.

### ☑ Timeline

- New JROTC Facility Opens Mar 2015

# Churchill HS JROTC Design & Construction Timeline



Project Schedule

Churchill High School  
North East ISD

# Churchill High School New JROTC Facility Expanded Design & Construction Schedule

---

- Design Phase: 29 Aug 2012 thru 12 Aug 2013
- Bidding Phase: 13 Aug 2013 thru 14 Oct 2013
- Contract Award: 14 Oct 2013
- Pre-Construction Services Phase: 15 Oct 2013 thru 1 Dec 2013
- Construction Phase (JROTC Facility): 2 Dec 2013 thru 1 Dec 2014
- Building Commissioning: 2 thru 22 Dec 2014
- New JROTC and Large Ensemble Practice Facility Opens: 5 Jan 2015
- Construction Phase (Tennis Courts): 6 Jan 2015 thru 27 Mar 2015





# Churchill High School Schematic Design Presentation 2011 Bond Program

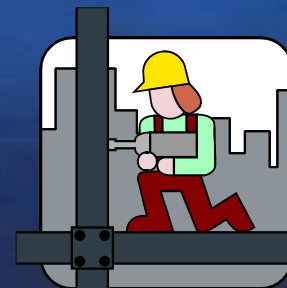

## Questions?