

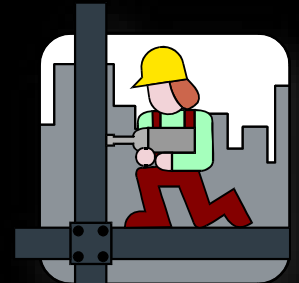

# Churchill High School Phase VI Additions and Renovations Project Schematic Design Presentation 2015 Bond Program



Garrett J. Sullivan, Executive Director  
Construction Management and Engineering Department

September 12, 2016

# Schematic Design Presentation Agenda

---

- Project Design Team
- Program Review
- Project Site Analysis
- Concept Design Plans
- Budget Review
- Project Phasing Plan
- Schedule Review
- Staff Recommendation



# Churchill High School Project Design Team

---

- Architect: Garza/Bomberger & Associates
- MEP Engineer: TTG Engineers
- Structural Engineer: R.S.C.R. Engineers
- Civil Engineer: Pape-Dawson Engineers
- Roofing Engineer: Wiss, Janey, Elstner & Associates
- Technology Engineer: Combs Consulting Group
- Fire Protection/Building Code Engineer: Protection Development, Inc.
- Landscape Architect: Cooper-Lochte Landscape Architects
- Food Service Engineer: Robert Simpson & Associates
- Acoustical Engineer: BAi
- Geotechnical & Material Testing: Raba-Kistner Consultants
- Test, Balance, and Commissioning: Energy Testing and Balance, Inc.





# Churchill High School Site Aerial (Aug 2016)



Campus Site Aerial (Aug 2016)

Churchill High School  
North East ISD



# 2015 Bond Program Review for Churchill HS

---

- New Career & Technical Education Facility
- 8 New Campus Science Lecture/Lab Classrooms
- 2<sup>nd</sup> Band Rehearsal Hall
- 2<sup>nd</sup> Orchestra Rehearsal Hall
- Dance Locker Room Addition
- Facility Renovations (Band, Orchestra, and Dance)

# 2015 Bond Program Review for Churchill HS

---

1. **New Career & Technical Education (CTE) and Campus Science Lab Addition (62,593 sq. ft.)**
  - a. CTE Business Marketing Education Program
  - b. CTE Family & Consumer Science Program
  - c. CTE Health Science Program
  - d. CTE Technology Education Program
  - e. CTE Teacher Resource Areas including a Work Room, Conference Room, Office Area, Teacher Work Stations, and Faculty Restrooms
  - f. Science Program - 8 Combination Science Lecture/Lab Classrooms for Churchill HS
  - g. Science Program Teacher Resource Area including a Work Room, Storage Area, Teacher Work Stations, and Faculty Restrooms
2. **New Orchestra Facility (8,231 sq. ft.) – Includes a 2<sup>nd</sup> Orchestra Rehearsal Hall**
3. **New Dance Locker Room (1,603 sq. ft.)**
3. **New Band Facility Restroom Addition (1,033 sq. ft.)**
4. **Facility Renovations (12,650 sq. ft.)**
  - a. Convert existing Orchestra Rehearsal Hall into 2<sup>nd</sup> Band Rehearsal Hall
  - b. Renovate existing Band Rehearsal Hall Area (LED Lighting, Flooring, and Painting)
  - c. Renovate existing Dance/Cheer Facility Area (LED Lighting, Flooring, and Painting)
  - d. Convert existing Dance Storage Area into a new High Density Mobile Storage Area
6. **Demo existing CTE Facility and replace with new Campus Parking Area**



# Churchill HS Project Site Analysis (CTE & Science Facilities)

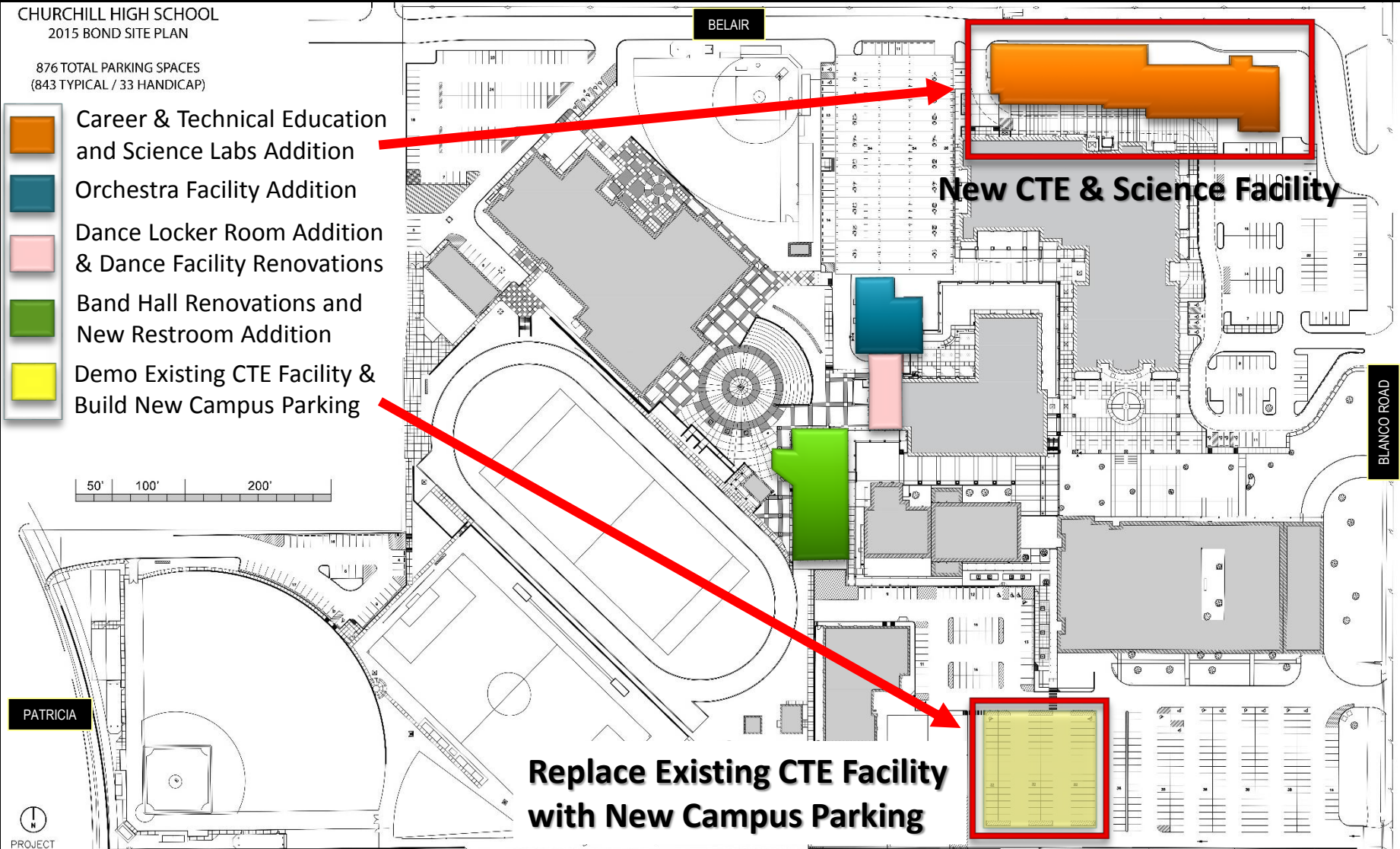

**Churchill High School**  
**North East ISD**

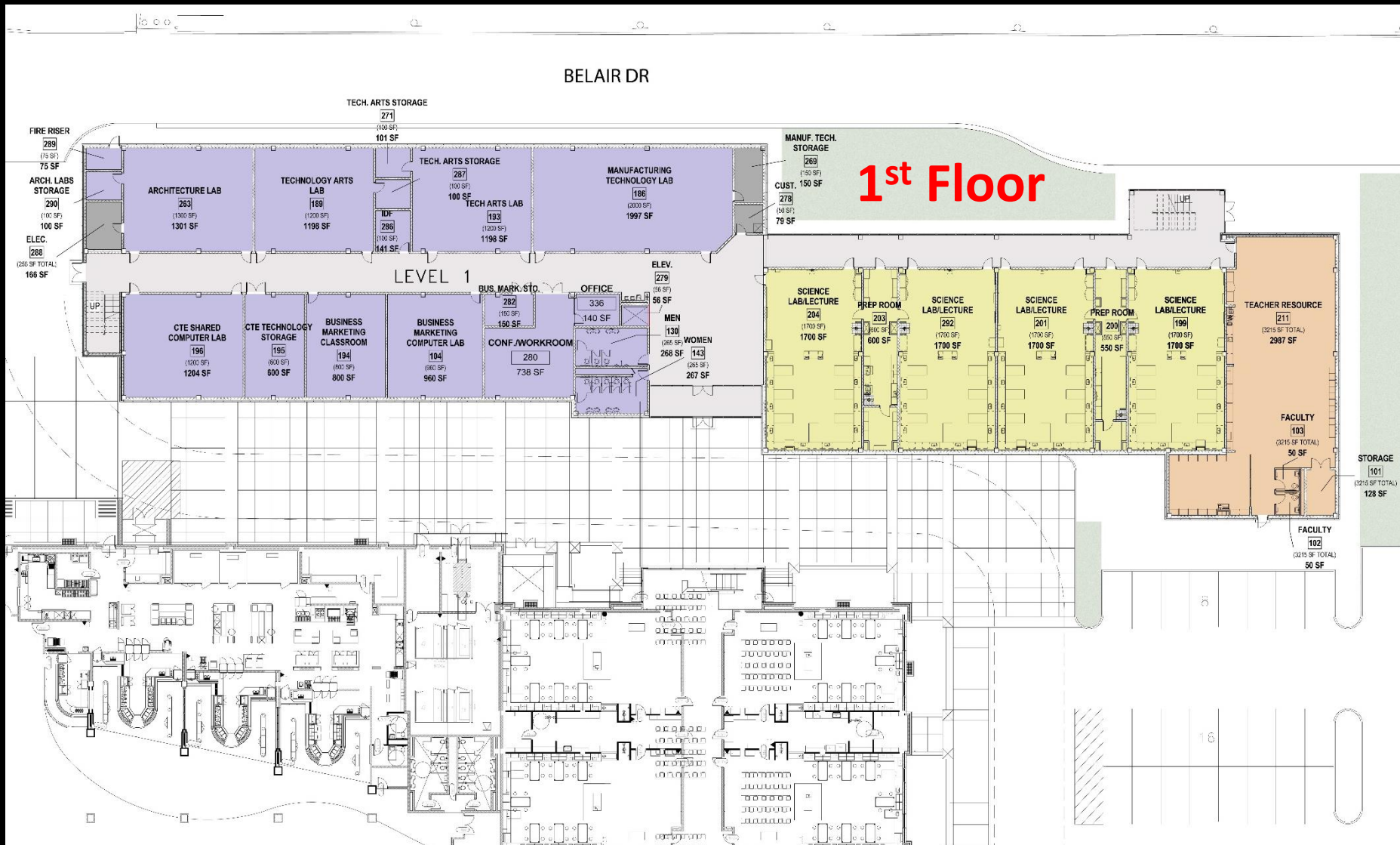



# Churchill HS New CTE and Science Facility Addition

## 1<sup>st</sup> Floor West

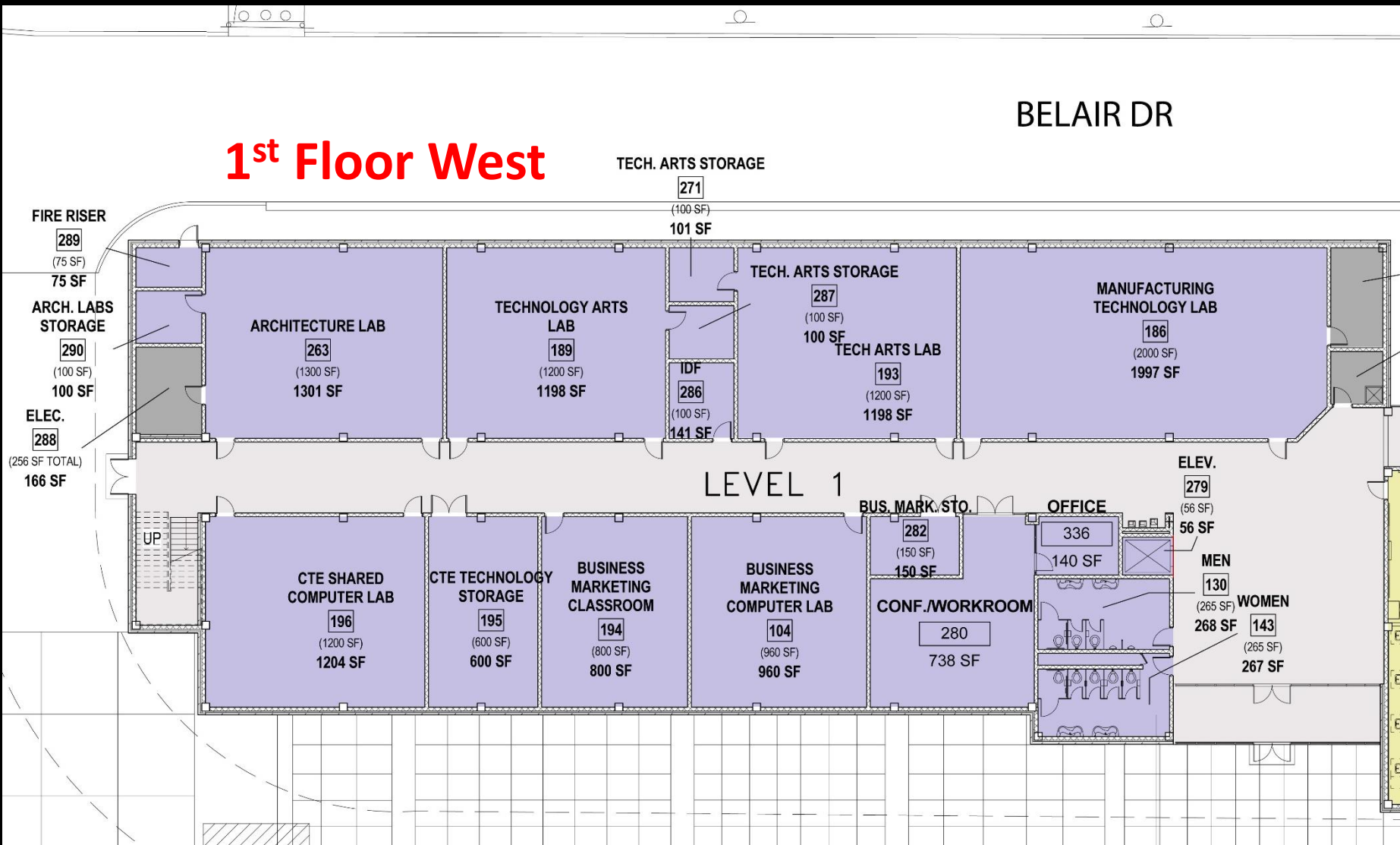

# Churchill HS New CTE and Science Facility Addition

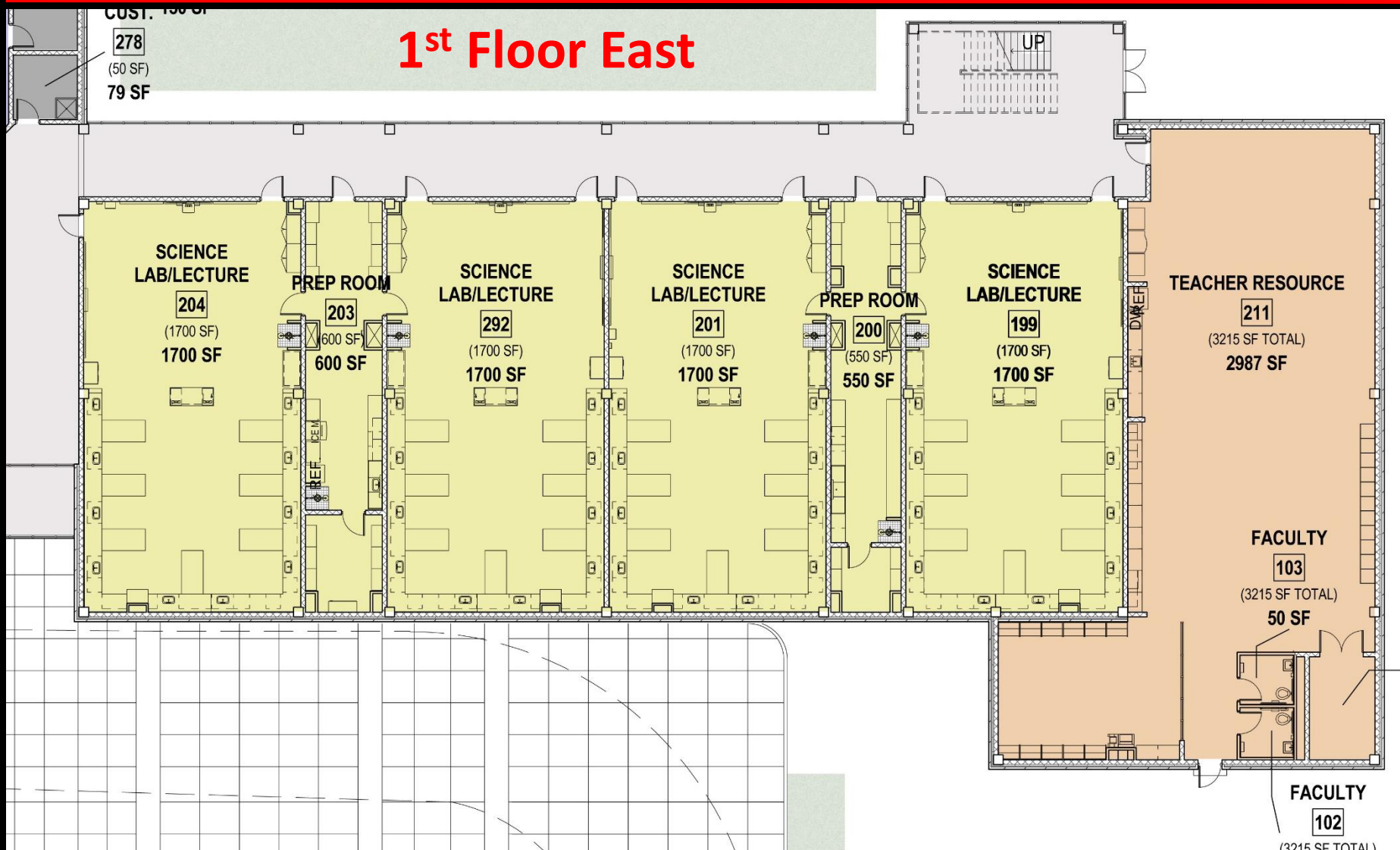

Science Facility Addition 1<sup>st</sup> Floor Plan

Churchill High School  
North East ISD



# Churchill HS New CTE and Science Facility Addition

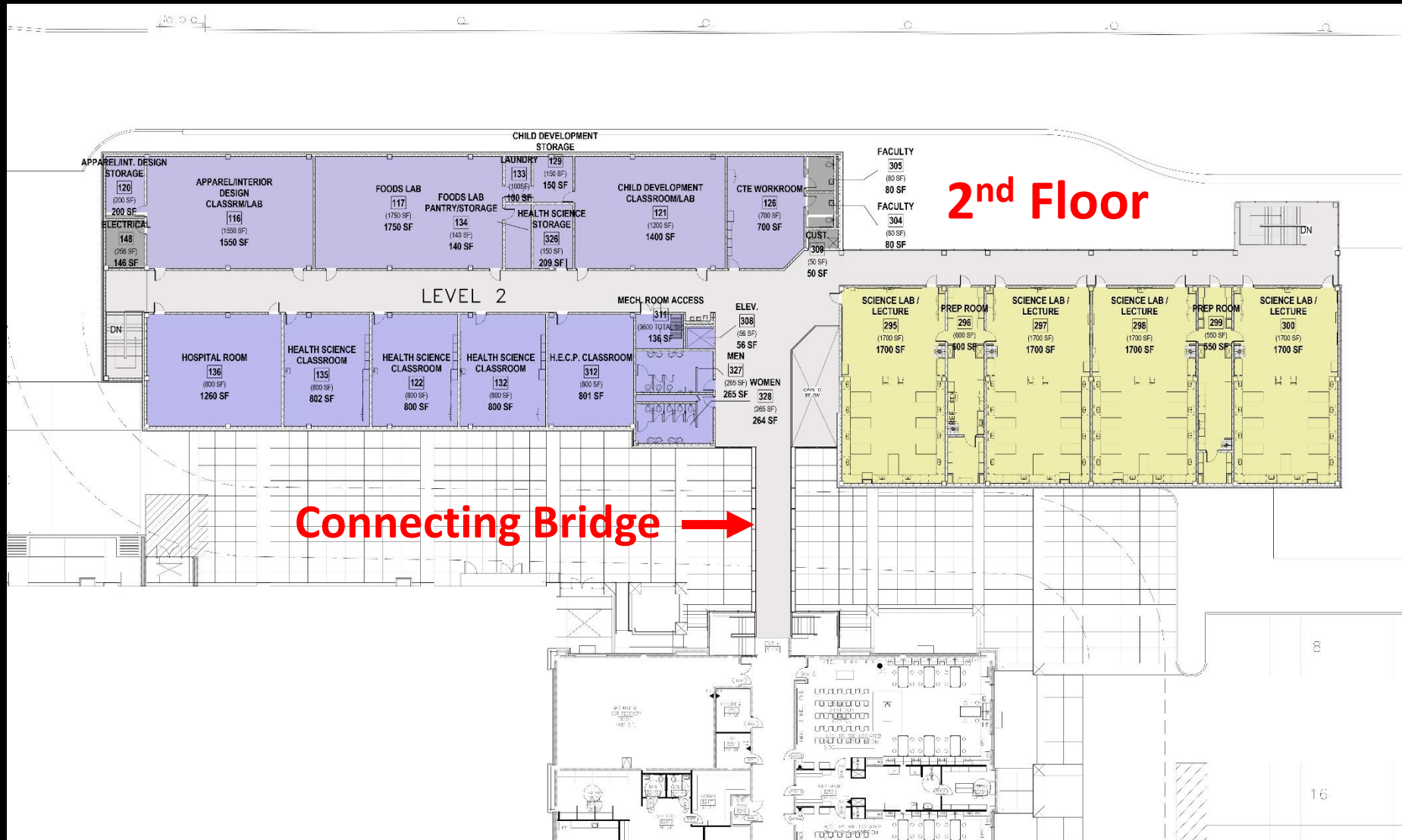

# Churchill HS New CTE and Science Facility Addition

## 2<sup>nd</sup> Floor West

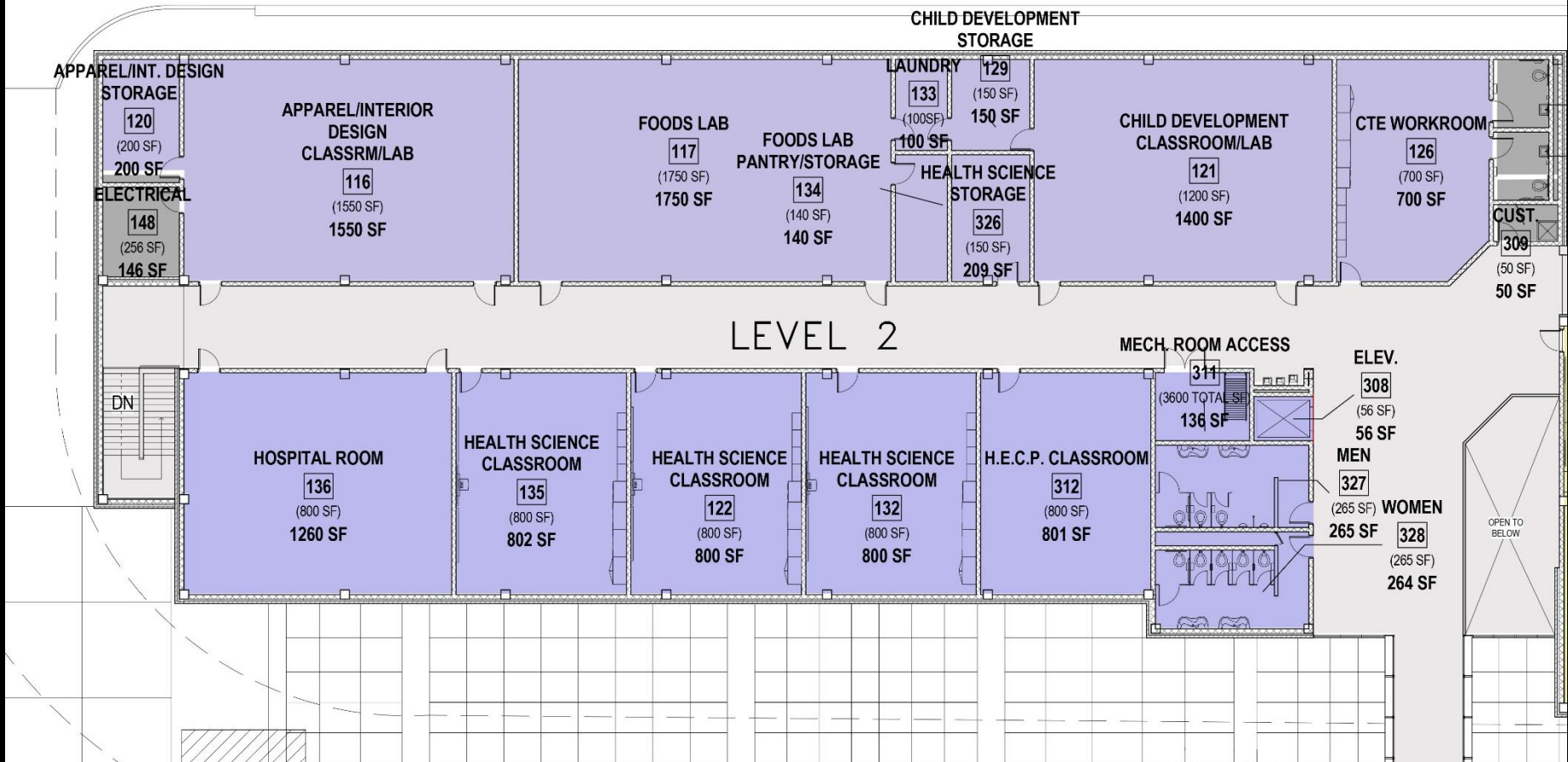



# Churchill HS New CTE and Science Facility Addition

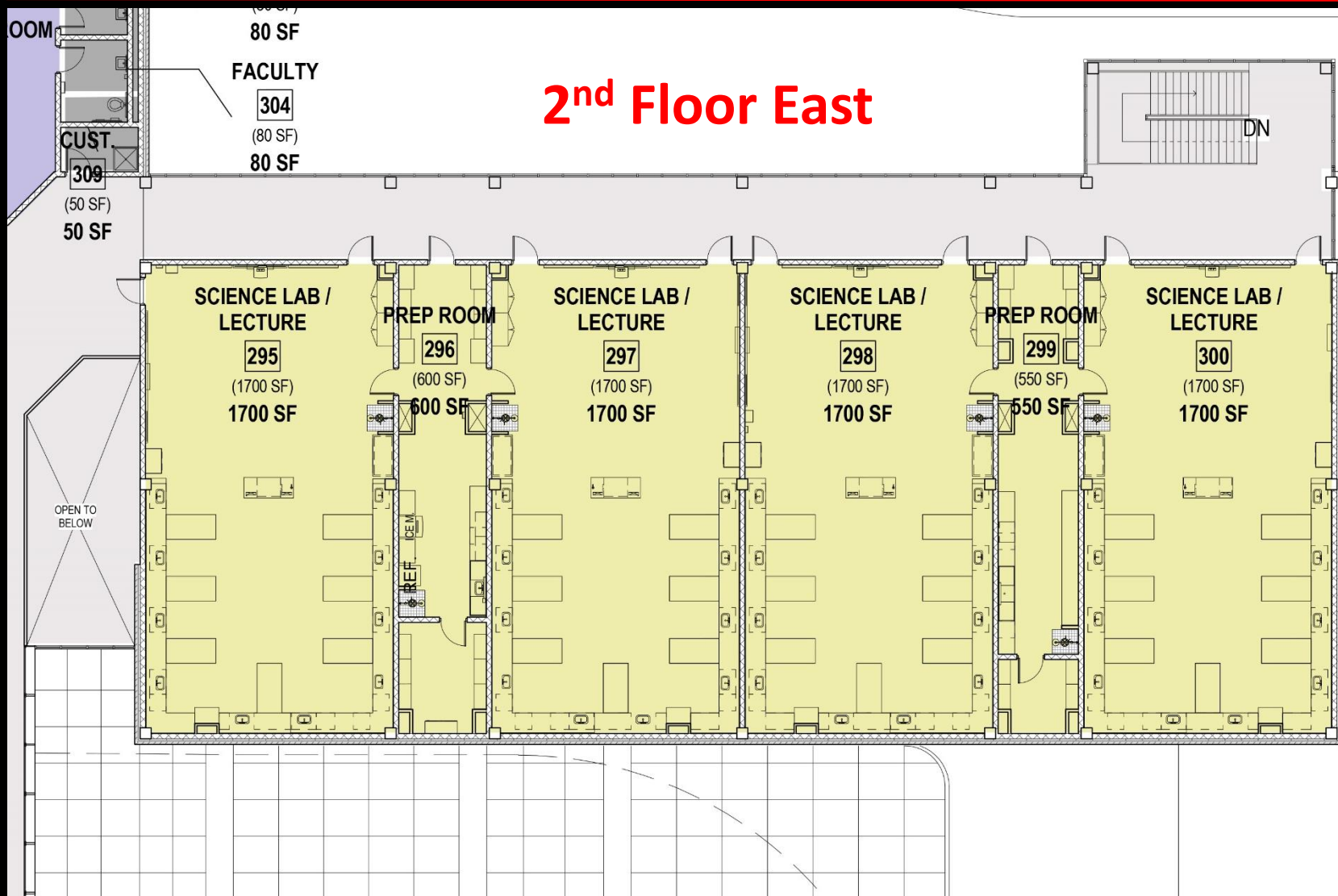

# Churchill HS CTE and Science Facility Perspective

---



**Churchill HS CTE and Science Facility Perspective**

*Churchill High School  
North East ISD*



# Churchill HS CTE and Science Facility Perspective

---



**Churchill HS CTE and Science Facility Perspective**

*Churchill High School  
North East ISD*



# Churchill HS Project Site Analysis (Fine Arts Facilities)

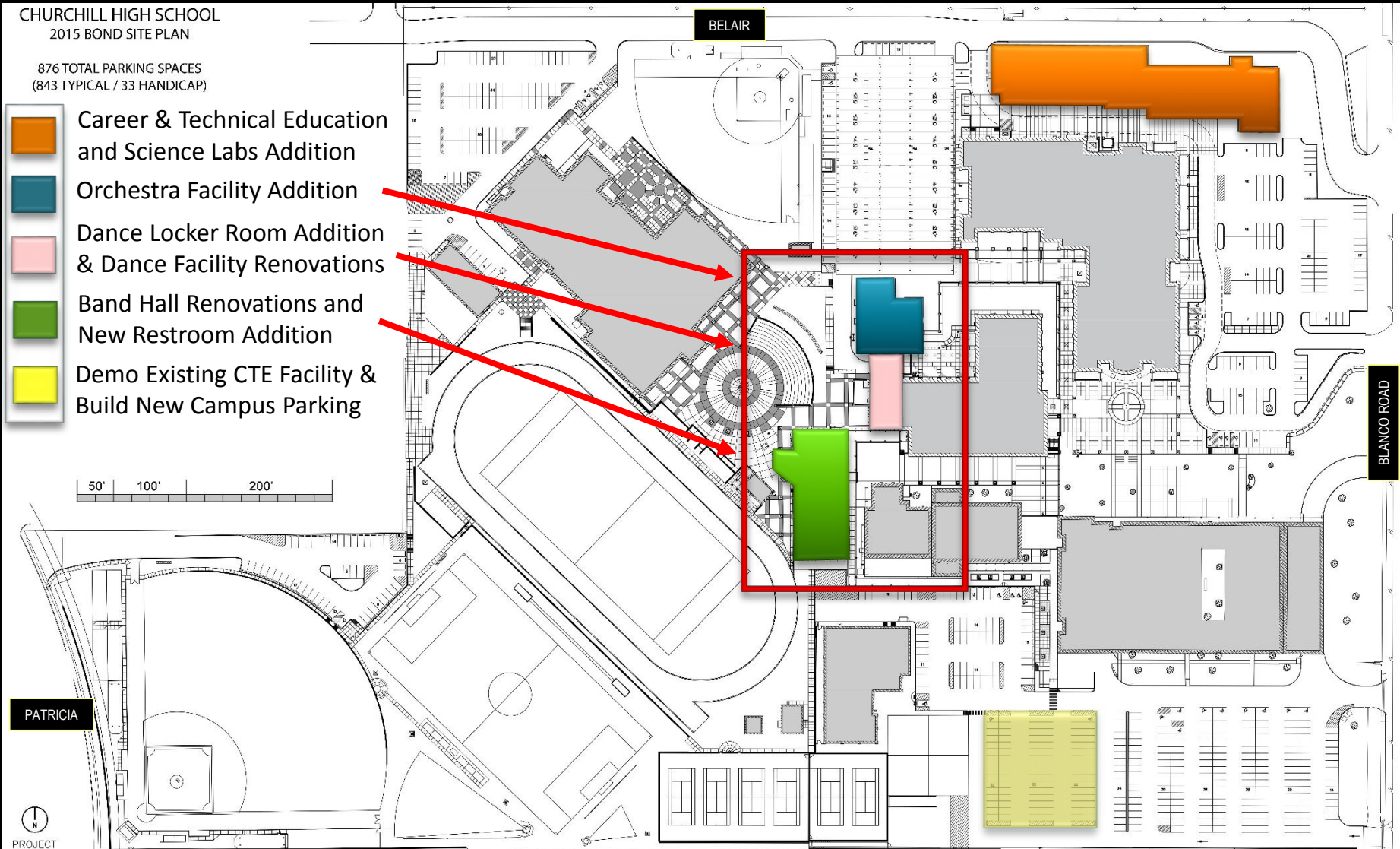

**Project Site Analysis - Fine Arts Facilities**

**Churchill High School  
North East ISD**

# Churchill HS New Fine Arts Facilities and Renovations



**Band, Orchestra, & Dance Facility Improvements**

**Churchill High School  
North East ISD**

# Churchill HS New Fine Arts Facilities and Renovations

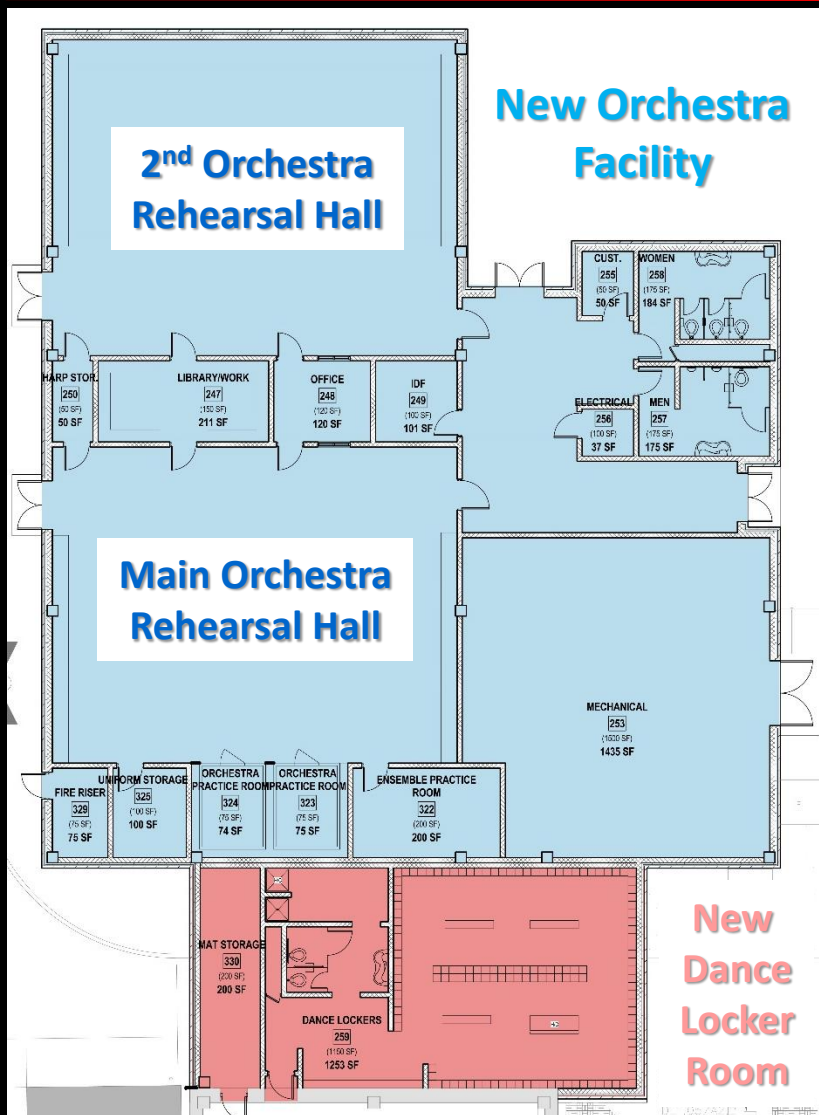

New Orchestra Facility, New Dance Locker Room  
Renovate existing Orchestra into Band Rehearsal Hall  
and add New Restroom Addition to Band Facility

**Band, Orchestra, & Dance Facility Improvements**

*Churchill High School  
North East ISD*



# Churchill HS New Fine Arts Facilities and Renovations

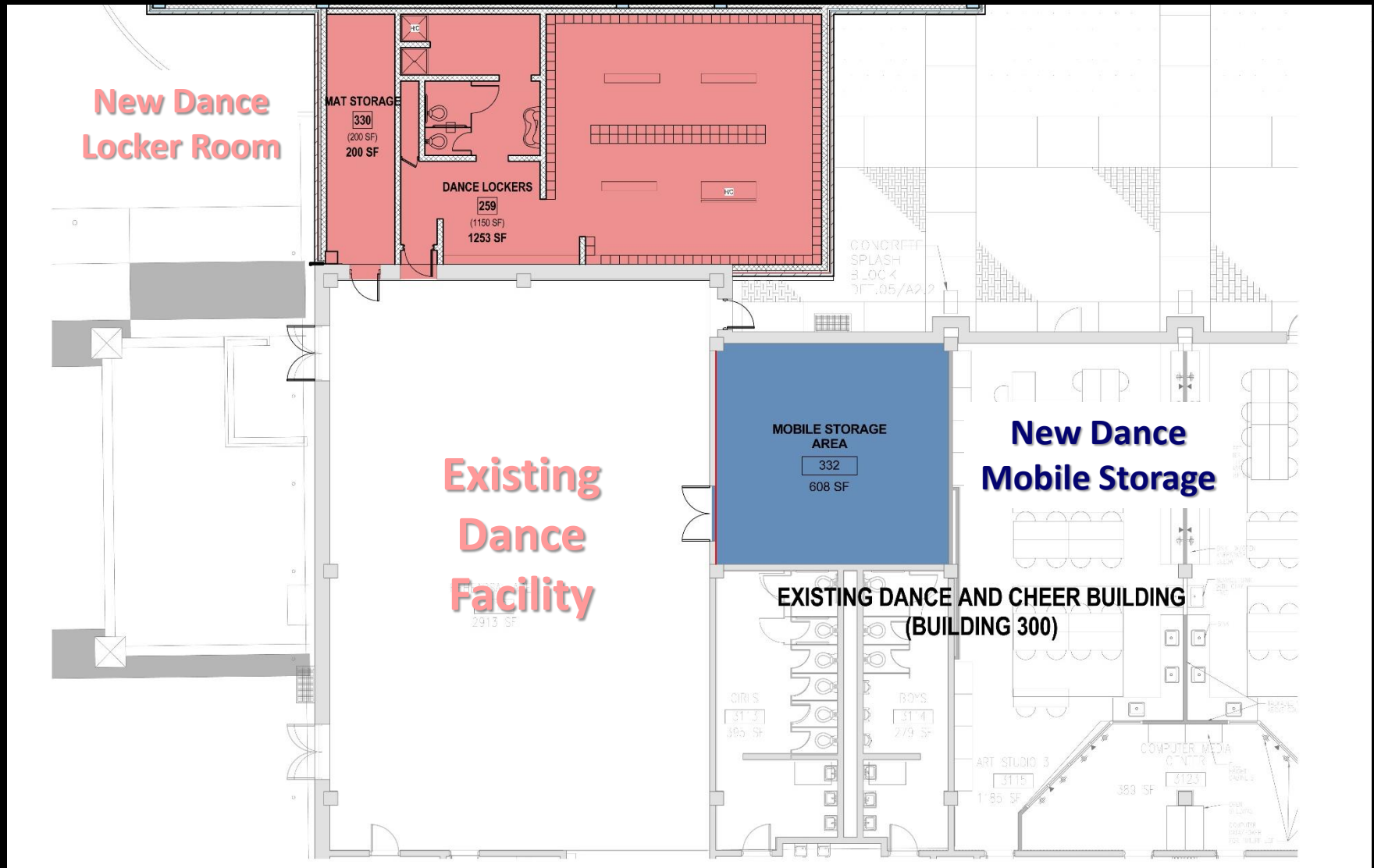

**Dance Facility Improvements**

**Churchill High School  
North East ISD**

# 2015 Bond Churchill HS Project Fly-Around

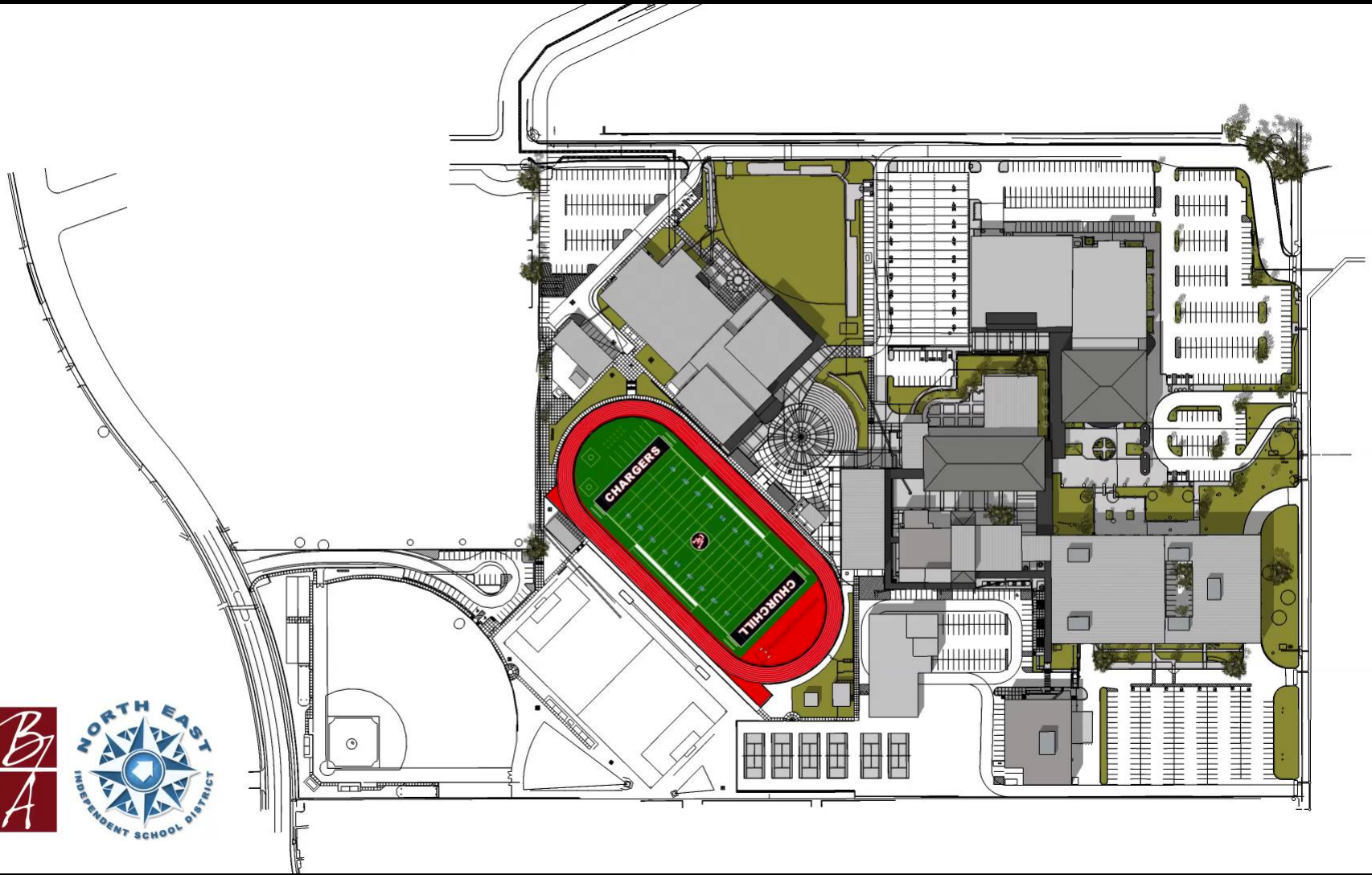

2015 Bond Churchill HS Project Fly-Around

*Churchill High School  
North East ISD*

# Future Bond Churchill HS Project Fly-Around

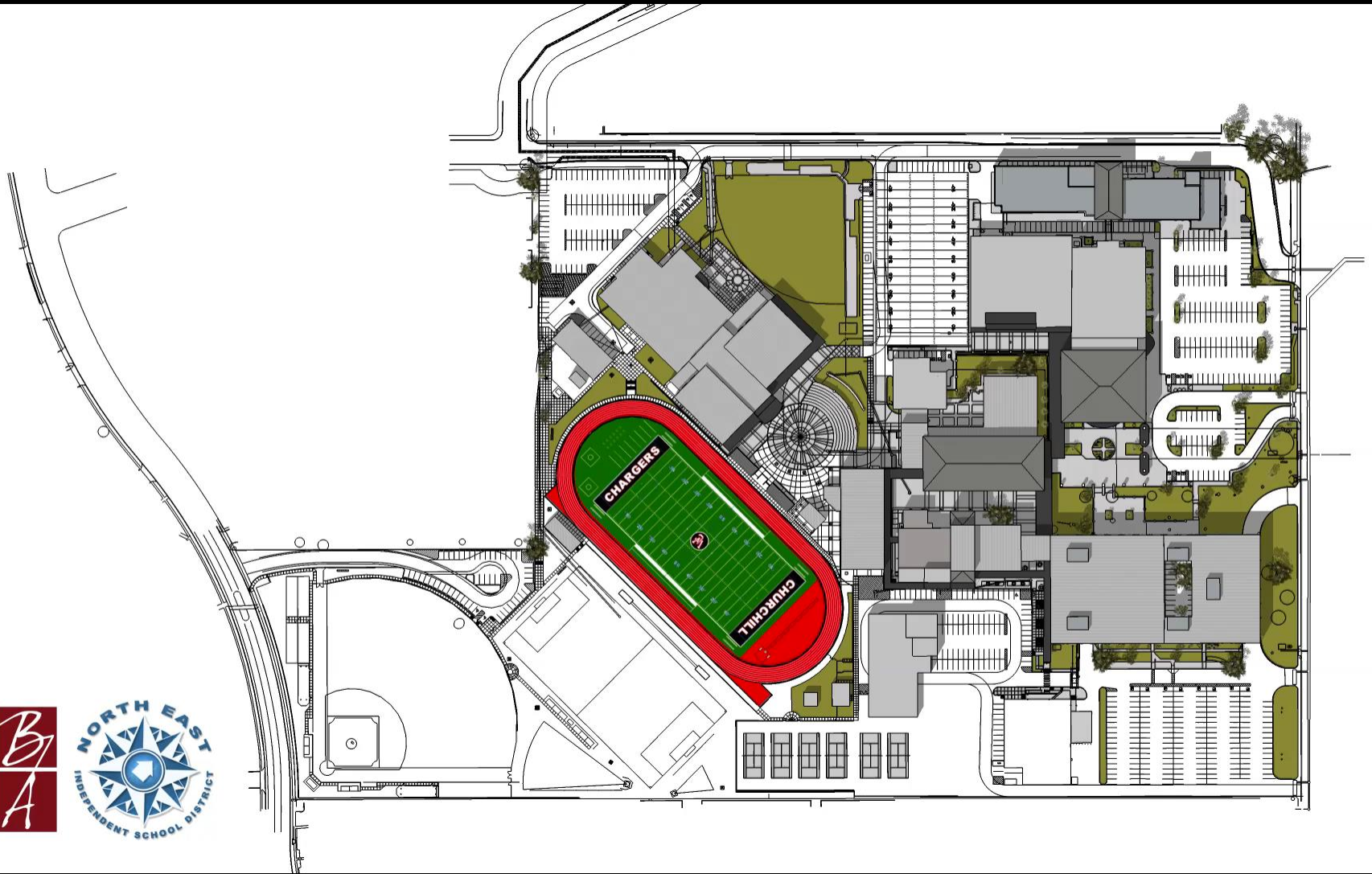

Future Bond Churchill HS Project Fly-Around

*Churchill High School*  
*North East ISD*



# 2015 Bond Budget Review for Churchill HS Project

---

• Design Account:	\$ 3,500,000
• Construction Account:	\$ 25,250,000
• Technology Account:	\$ 300,000
• FF&E Account:	<u>\$ 1,200,000</u>
TOTAL BOND PROGRAM =	\$ 30,250,000

# Churchill HS Construction Phasing Plan (Phase 1)

CHURCHILL HIGH SCHOOL  
2015 BOND SITE PLAN

876 TOTAL PARKING SPACES  
(843 TYPICAL / 33 HANDICAP)

- 1** Career & Technical Education and Science Labs Addition
- 1** Orchestra Facility Addition
- 1** Dance Locker Room Addition
- 3** Demo Existing CTE Facility & Build New Campus Parking
- 1** Band Hall Restroom Addition

50' 100' 200'



PROJECT

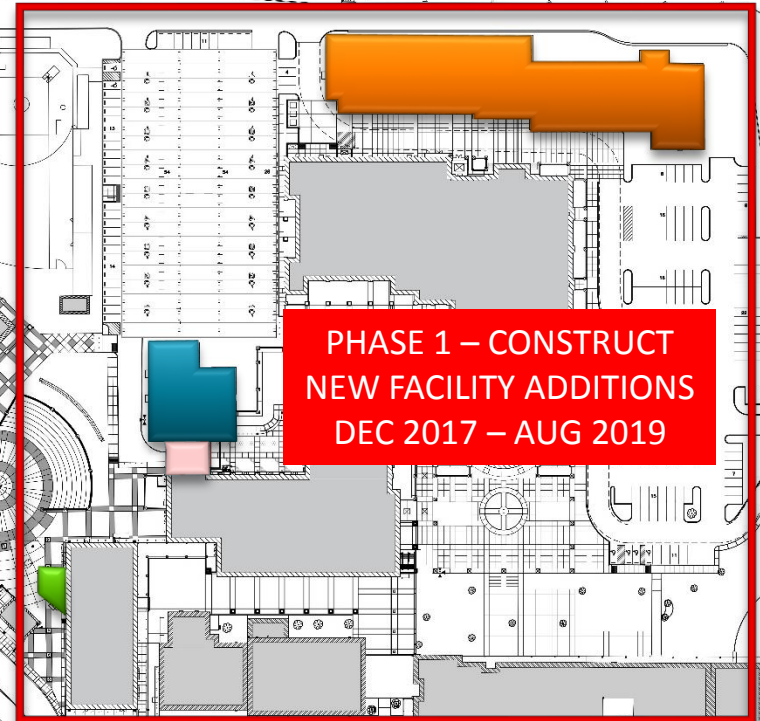

**PHASE 1 – CONSTRUCT  
NEW FACILITY ADDITIONS  
DEC 2017 – AUG 2019**

# Churchill HS Construction Phasing Plan (Phase 2)

CHURCHILL HIGH SCHOOL  
2015 BOND SITE PLAN

876 TOTAL PARKING SPACES  
(843 TYPICAL / 33 HANDICAP)

1

Career & Technical Education  
and Science Labs Addition

1

Orchestra Facility Addition

2

Dance Locker Room Addition  
& Dance Facility Renovations

3

Demo Existing CTE Facility &  
Build New Campus Parking

2

Band Hall Restroom Addition  
and Band Hall Renovations

50' 100' 200'



PROJECT

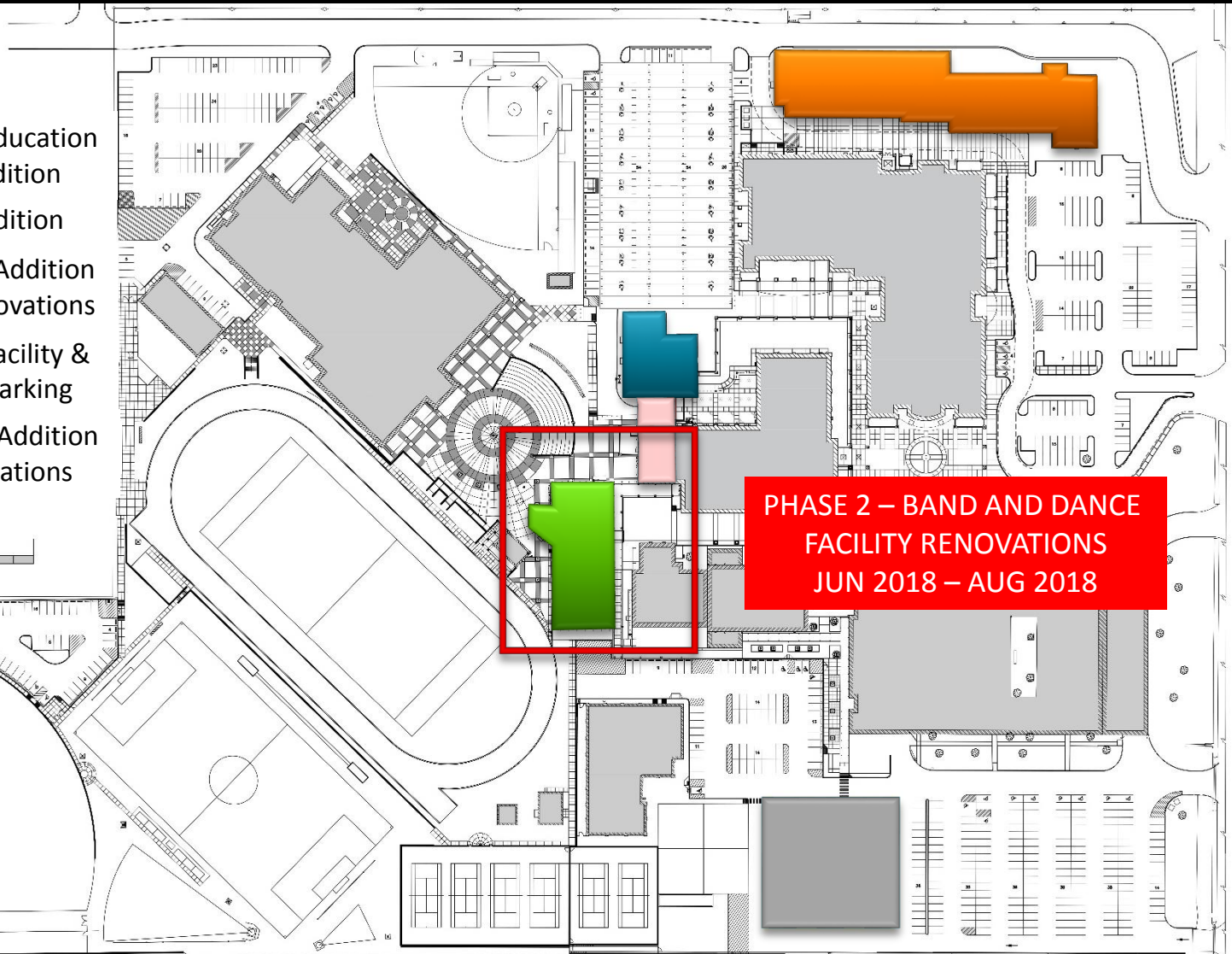

PHASE 2 – BAND AND DANCE  
FACILITY RENOVATIONS  
JUN 2018 – AUG 2018



# Churchill HS Construction Phasing Plan (Phase 3)

CHURCHILL HIGH SCHOOL  
2015 BOND SITE PLAN

876 TOTAL PARKING SPACES  
(843 TYPICAL / 33 HANDICAP)

1

Career & Technical Education  
and Science Labs Addition

1

Orchestra Facility Addition

3

Dance Locker Room Addition  
& Dance Facility Renovations

3

Demo Existing CTE Facility &  
Build New Campus Parking

3

Band Hall Restroom Addition  
and Band Hall Renovations

50' 100' 200'

PHASE 3 – CAMPUS  
RELOCATES  
ORCHESTRA FF&E  
FROM EXISTING  
BAND FACILITY TO  
NEW ORCHESTRA  
FACILITY ADDTION  
AUG 2019

PHASE 3 – CAMPUS  
RELOCATES CTE FF&E  
FROM EXISTING FACILITY  
TO NEW CTE FACILITY  
ADDTION  
AUG 2019

PHASE 3 – DEMO EXISTING CTE FACILITY  
AND REPLACE WITH NEW PARKING  
AUG – OCT 2019

PROJECT

# Churchill HS Construction Phasing Plan (Phase 4)

CHURCHILL HIGH SCHOOL  
2015 BOND SITE PLAN

876 TOTAL PARKING SPACES  
(843 TYPICAL / 33 HANDICAP)

- C** Career & Technical Education and Science Labs Addition
- C** Orchestra Facility Addition
- C** Dance Locker Room Addition & Dance Facility Renovations
- C** Demo Existing CTE Facility & Build New Campus Parking
- 4** Band Hall Restroom Addition and Band Hall Renovations

50' 100' 200'



PROJECT

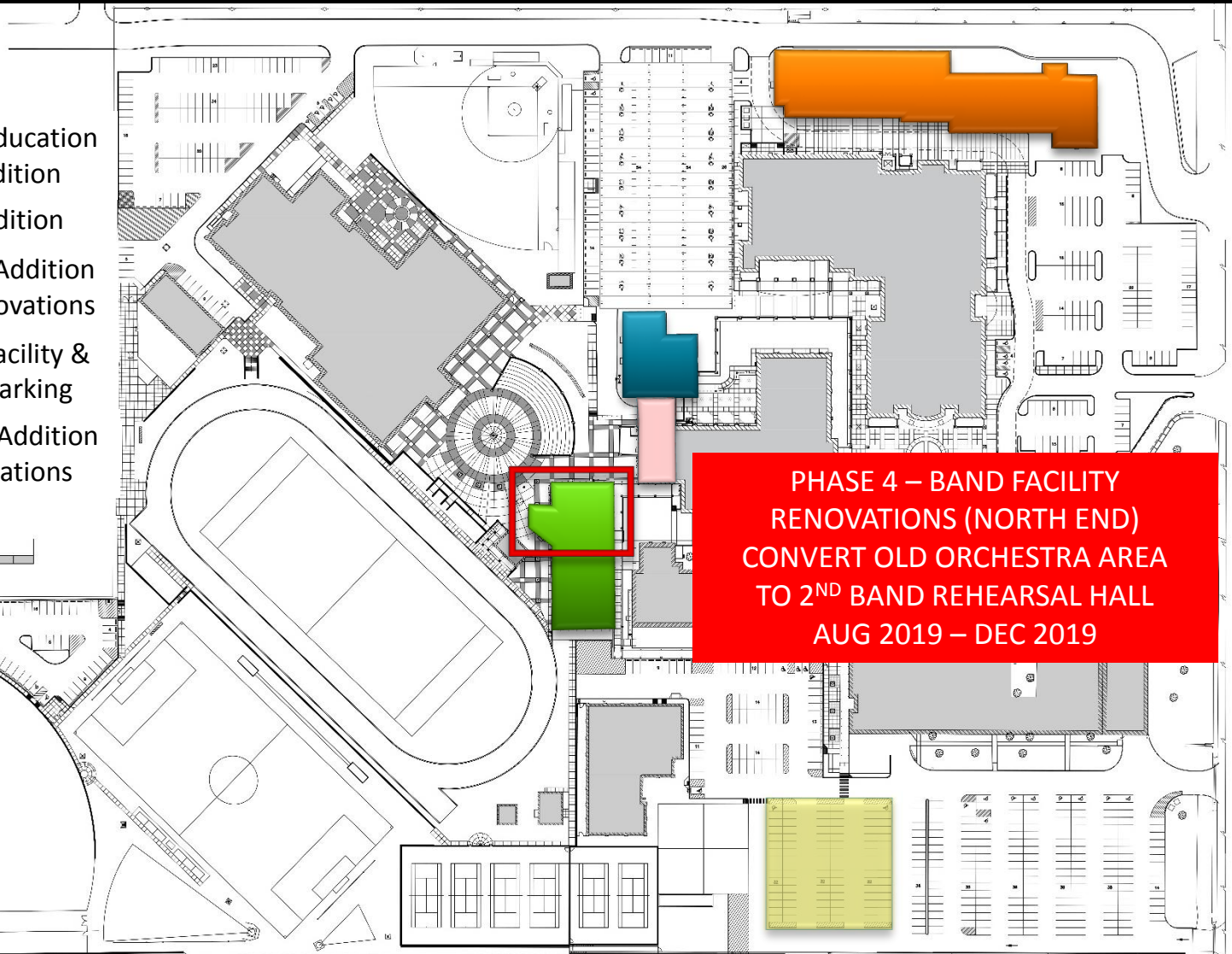

**PHASE 4 – BAND FACILITY  
RENOVATIONS (NORTH END)  
CONVERT OLD ORCHESTRA AREA  
TO 2<sup>ND</sup> BAND REHEARSAL HALL  
AUG 2019 – DEC 2019**



# 2015 Bond Design & Construction Timeline





# Churchill HS 2015 Bond Project

## District Staff Recommendation

---

- Recommend Approval of Churchill High School Schematic Design Presentation which Constructs the following 2015 Bond-Approved Program Elements:
  - New CTE and Science Lab Facility Addition
  - 2<sup>nd</sup> Orchestra Rehearsal Hall
  - 2<sup>nd</sup> Band Rehearsal Hall
  - Dance Locker Room Addition
  - Facility Renovations (Band, Orchestra, and Dance Areas)
  - Demo existing CTE Facility and replace with new Campus Parking
  - Construction Budget = \$25,250,000



# Churchill High School CTE, Science & Fine Arts Addition and Renovations Schematic Design Presentation 2015 Bond Program

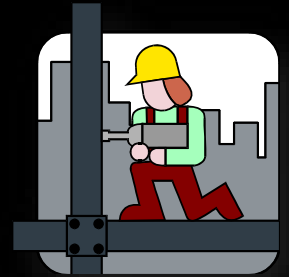

## Questions ?