

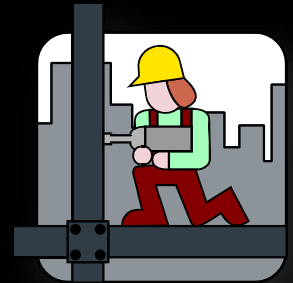

2015 Bond Hidden Forest Elementary School Additions and Renovations Project Schematic Design Presentation

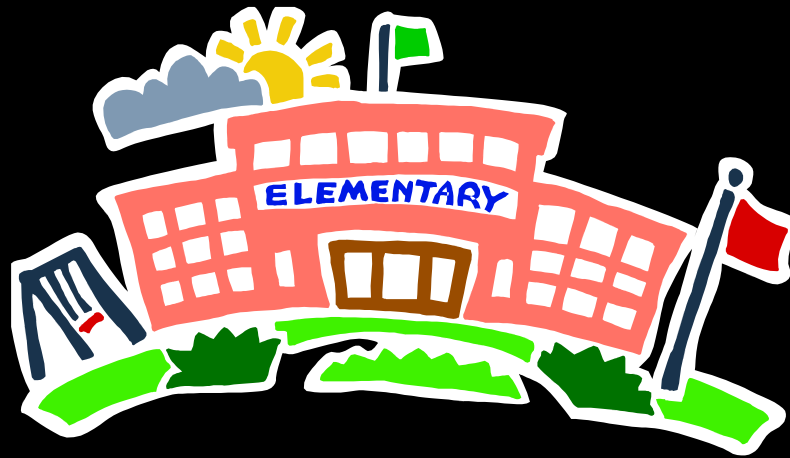

Garrett J. Sullivan, Executive Director
Construction Management and Engineering Department

August 14, 2017

Schematic Design Presentation Agenda

- Project Design Team
- Program Review
- Project Site Analysis
- Concept Design Plans
- Budget Review
- Project Phasing Plan
- Schedule Review
- Staff Recommendation



Hidden Forest Elem. School Project Design Team

- Architect: DeMunbrun Scarnato Associates
- MEP Engineer: Ms2 Consulting Engineers
- Structural Engineer: Lundy Franke Engineering
- Civil Engineer: Pape-Dawson Engineers
- Roofing Engineer: Wiss, Janey, Elstner & Associates
- Technology Engineer: Combs Consulting Group
- Building Code Engineer: Protection Development, Inc.
- Landscape Architect: Cooper-Lochte
- Acoustical Engineer: Wrightson, Johnson, Haddon, and Williams
- Geotechnical & Material Testing: Arias & Associates
- Test, Balance, and Commissioning: Engineered Air Balance

Hidden Forest Elem. School Campus Site Aerial



Hidden Forest Elementary School Campus Site Aerial

*Hidden Forest ES
North East ISD*

Hidden Forest Elem. School Campus Site Aerial



Hidden Forest Elementary School Campus Site Aerial

*Hidden Forest ES
North East ISD*

2015 Bond Program Review for Hidden Forest Elem. School Additions and Renovations

- Expand/Renovate Administrative and Counseling Areas (4,925 sq. ft.)
- Construct a New Athletic Facility (7,250 sq. ft.)
- Repurpose/Renovate Existing Athletic Facility into New Cafeteria and Teacher Dining Areas and Renovate Existing Stage Area (6,575 sq. ft.)
- Construct Various Site Infrastructure Improvements to Support the Overall Project (Landscape, Irrigation, Drainage, Site Utilities, Asphalt, and Hardscape)
- Replace Existing Classroom Folding Accordion Partitions in Main Academic Building

Hidden Forest Elem. School Project Site Analysis

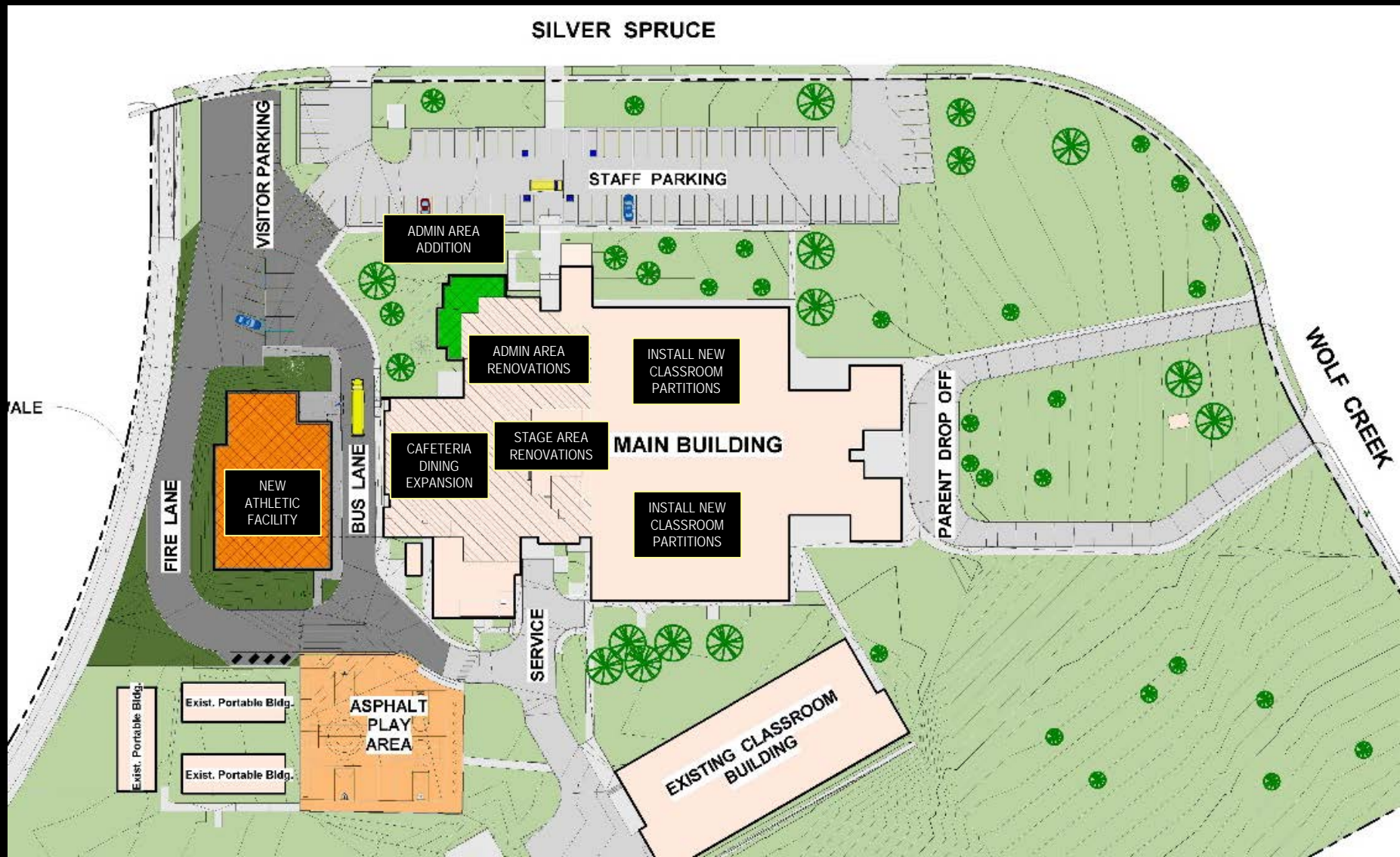

NEW ATHLETIC FACILITY

CAFETERIA DINING EXPANSION

STAGE AREA RENOVATIONS

INSTALL NEW CLASSROOM PARTITIONS

INSTALL NEW CLASSROOM PARTITIONS

SCHEMATIC DESIGN FLOOR PLAN

NEW GYMNASIUM BUILDING

Hidden Forest Elem. School Project Site Analysis

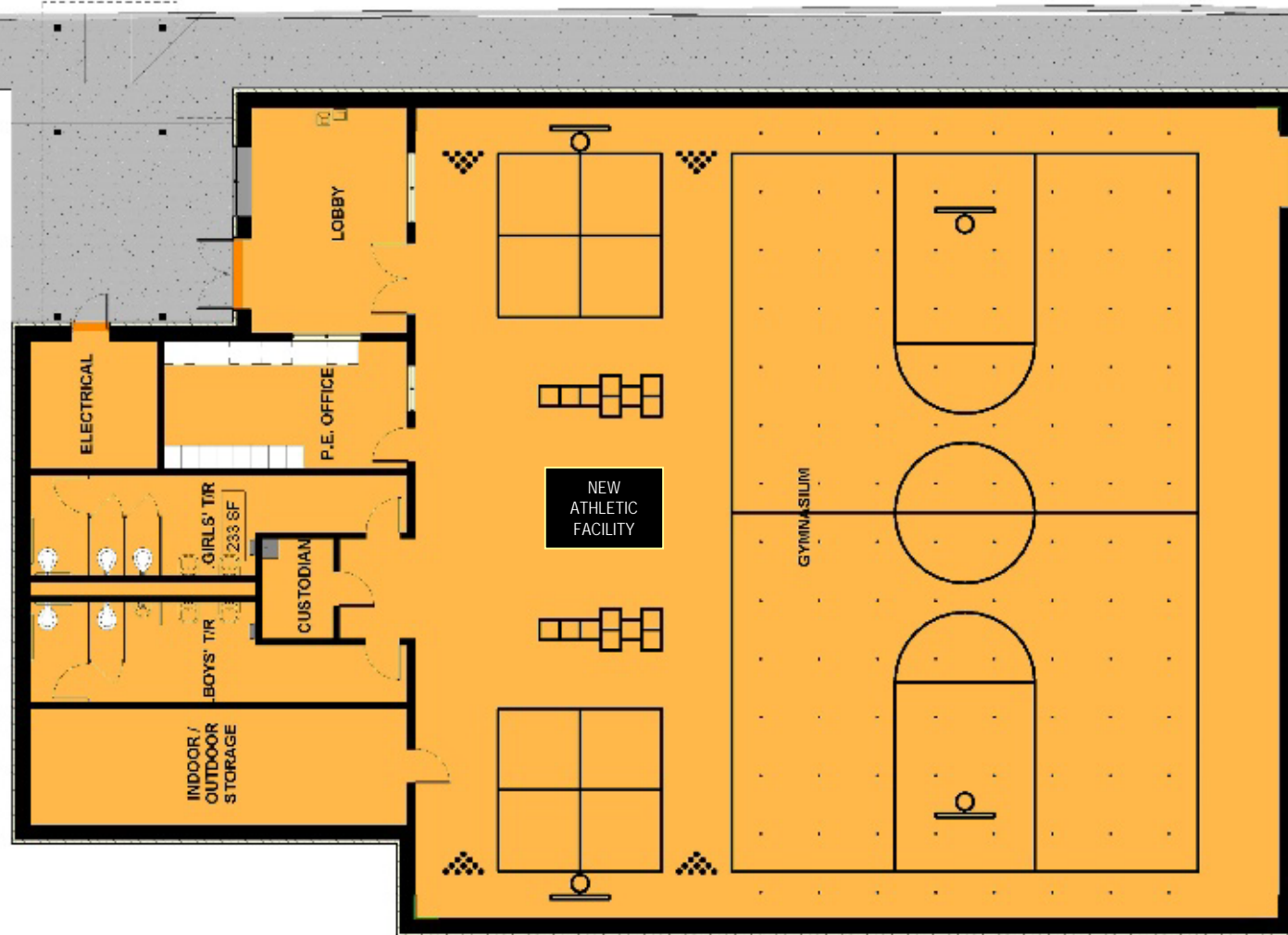

Total Facility Program = 7,250 sq. ft.

Hidden Forest Elem. School Project Site Analysis

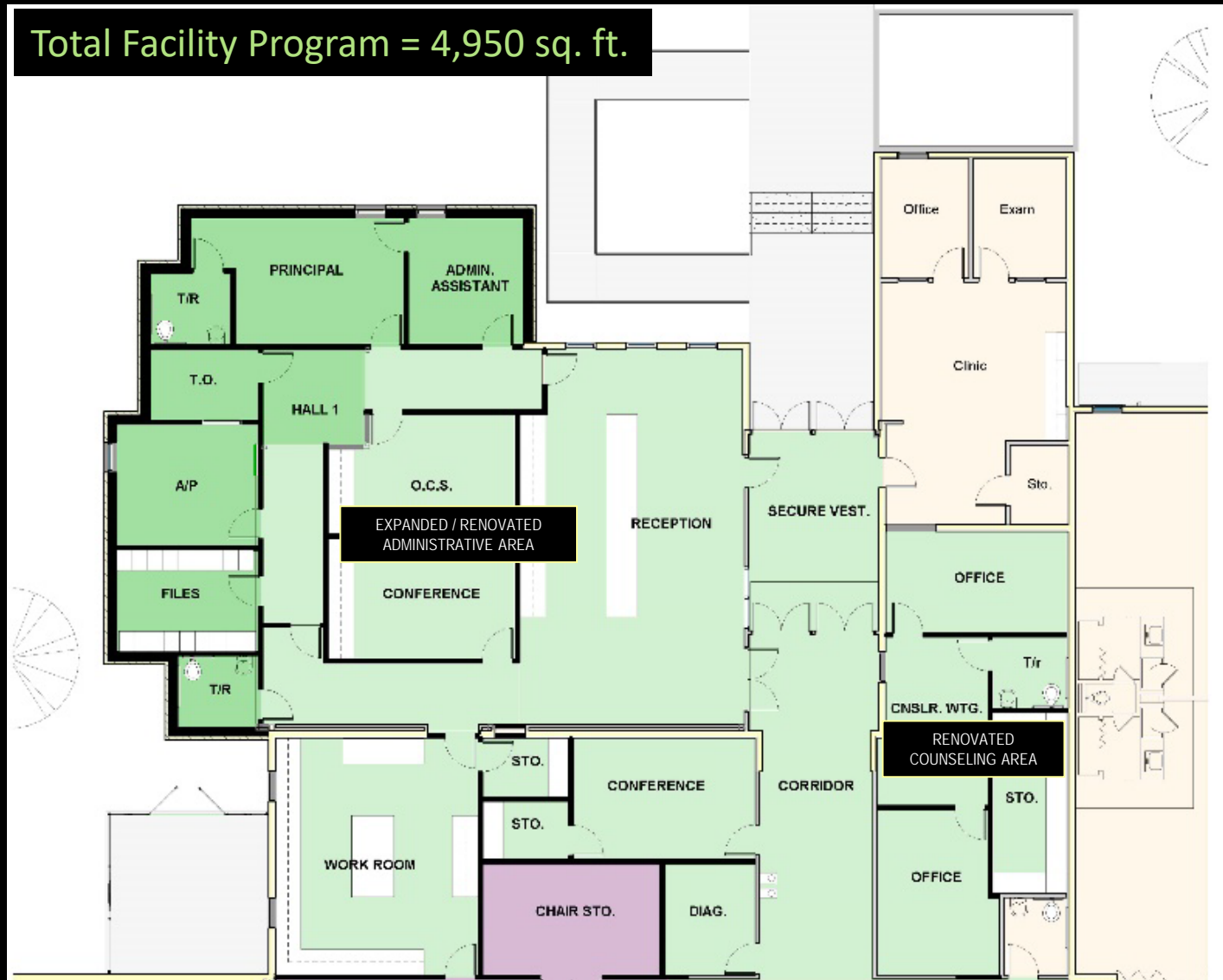

Hidden Forest Elem. School Project Site Analysis

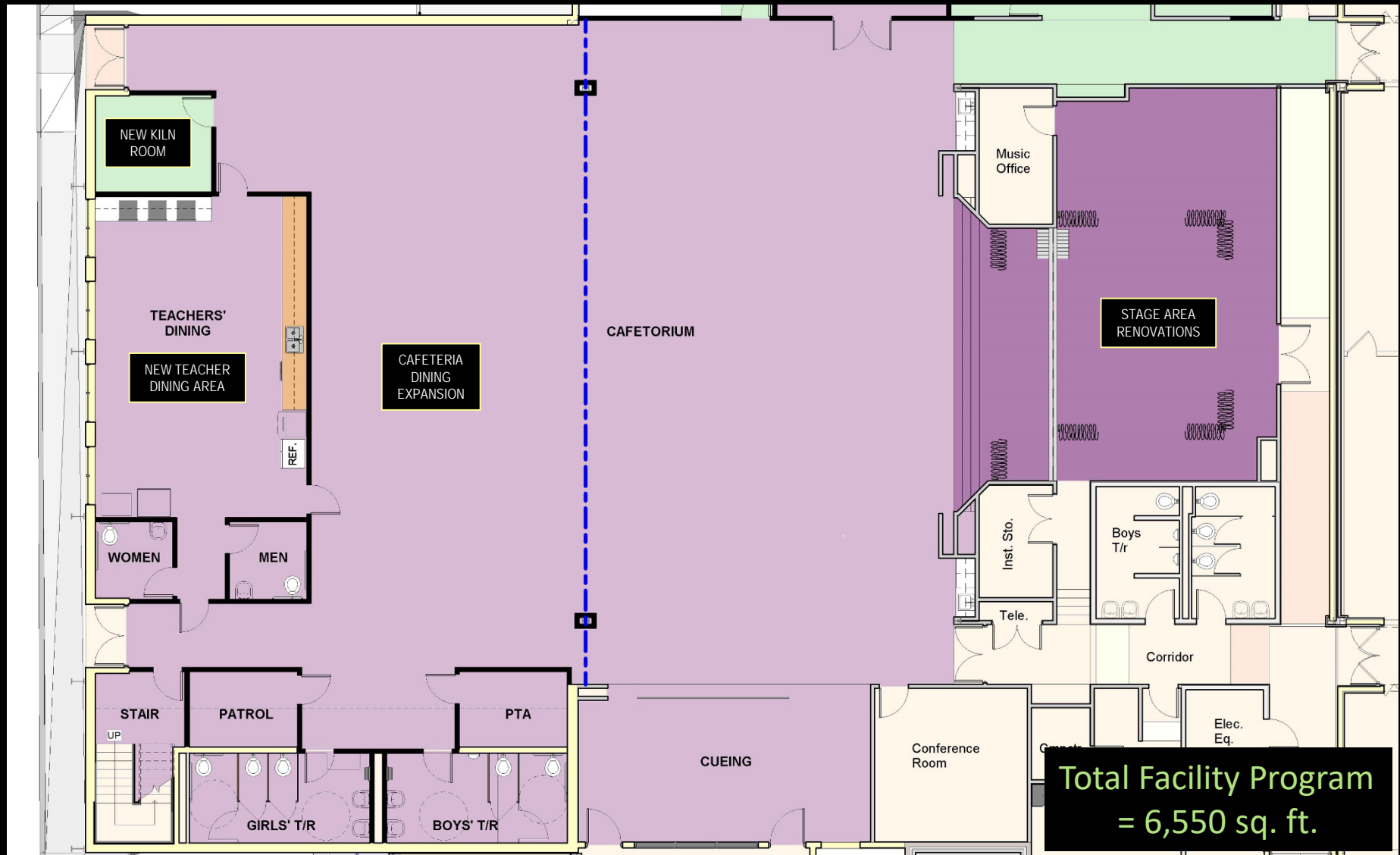

Hidden Forest Elem. School Project Site Analysis

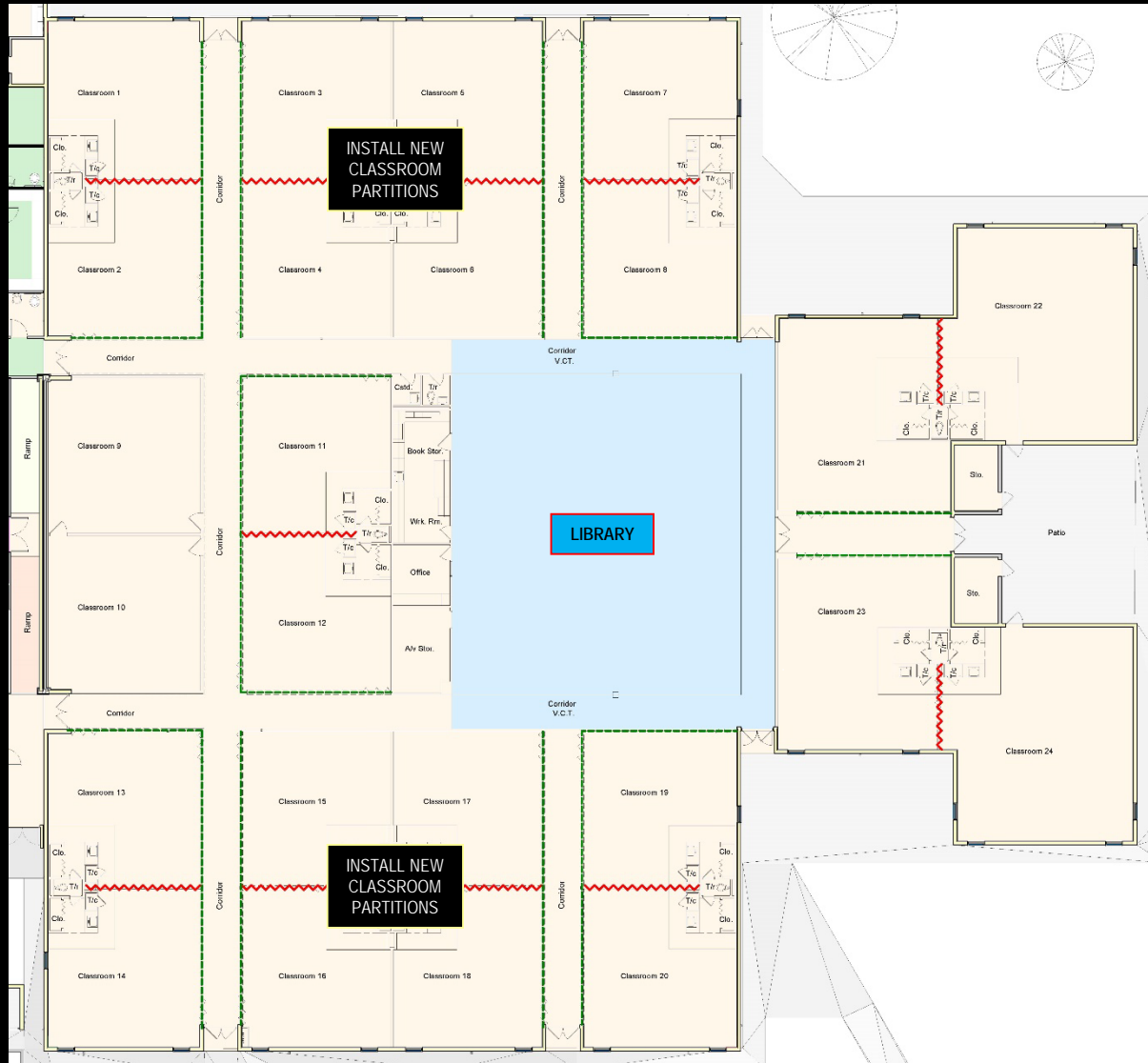

Hidden Forest Elem. School Campus Perspective



Hidden Forest ES Additions and Renovations Campus Perspective

*Hidden Forest ES
North East ISD*

Hidden Forest Elem. School Project Perspective

View Looking at School Front Entrance



Hidden Forest Elem. School Project Perspective

View Looking East at Admin Expansion and New Athletic Facility



Hidden Forest Elem. School Project Perspective

View Looking West at New Athletic Facility



2015 Bond Budget Review for Hidden Forest Elem. School Additions and Renovations

• Design Account:	\$ 900,000
• Construction Account:	\$ 7,850,000
• Technology Account:	\$ 10,000
• FF&E Account:	<u>\$ 315,000</u>
TOTAL BOND PROGRAM =	\$ 9,075,000

2015 Bond Design and Construction Timeline

16 MONTHS (MAR 2017 – JUN 2018)

PROJECT DESIGN

JUN 2018

2 MONTHS

BID AWD PCS

AUG 2018

16 MONTHS (SEP 2018 – DEC 2019)

DEC 2019

CONSTRUCT NEW ATHLETIC FACILITY

EXPAND / RENOVATE ADMINISTRATIVE
AND COUNSELING AREAS

EXPAND / RENOVATE CAFETERIA DINING AREA

RELOCATE TEACHER DINING AREA

CONSTRUCT VARIOUS SITE IMPROVEMENTS

INSTALL NEW CLASSROOM PARTITIONS
IN MAIN ACADEMIC BUILDING

2015 Bond Hidden Forest Elementary School Additions and Renovations Project - District Staff Recommendation

- Recommend Approval of the Hidden Forest Elementary School Additions and Renovations Project Schematic Design Presentation which Constructs the following 2015 Bond-Approved Program Elements:
 - Expand/Renovate Administrative and Counseling Areas (4,925 sq. ft.)
 - Construct a New Athletic Facility (7,250 sq. ft.)
 - Repurpose/Renovate Existing Athletic Facility into New Cafeteria and Teacher Dining Areas and Renovate Existing Stage Area (6,575 sq. ft.)
 - Construct Various Site Infrastructure Improvements to Support the Overall Project (Landscape, Irrigation, Drainage, Site Utilities, Asphalt, and Hardscape)
 - Replace Existing Classroom Folding Accordion Partitions in Main Academic Building
 - Construction Budget = \$ 7,850,000



2015 Bond Hidden Forest Elementary School Additions and Renovations Project Schematic Design Presentation

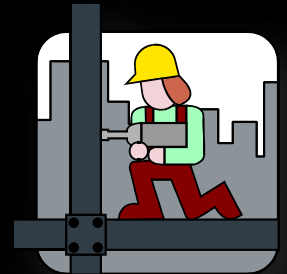

Questions ?