

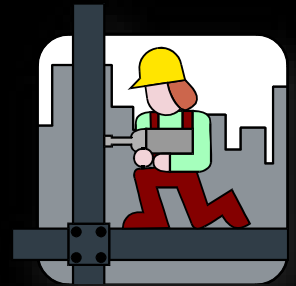

Jackson Middle School Phase 2 Campus Replacement Project Schematic Design Presentation 2015 Bond Program

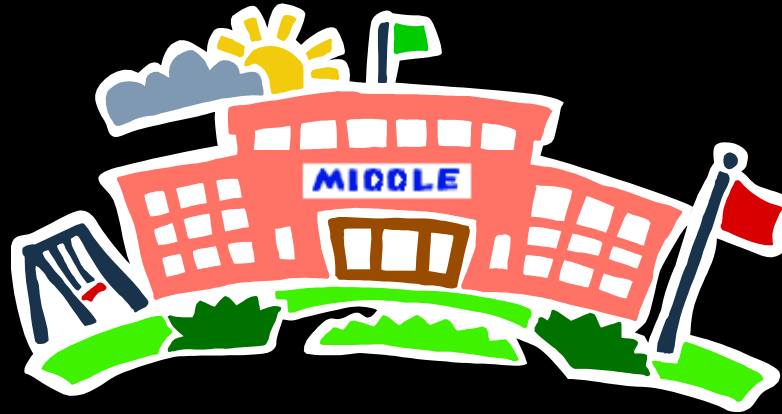

Garrett J. Sullivan, Executive Director
Construction Management and Engineering Department

October 10, 2016

Schematic Design Presentation Agenda

- Project Design Team
- Program Review
- Project Site Analysis
- Concept Design Plans
- Budget Review
- Project Phasing Plan
- Schedule Review
- Staff Recommendation



Jackson Middle School Project Design Team

- Architect: Pfluger Architects
- MEP Engineer: HMG & Associates
- Structural Engineer: Alpha Consulting Engineers
- Civil Engineer: Pape-Dawson Engineers
- Roofing Engineer: Wiss, Janey, Elstner & Associates
- Technology Engineer: Cleary Zimmermann Engineers
- Fire Protection/Building Code Engineer: Protection Development, Inc.
- Landscape Architect: Cooper-Lochte Landscape Architects
- Food Service Engineer: Robert Simpson & Associates
- Acoustical Engineer: BAI
- Geotechnical & Material Testing: Fugro Consultants
- Test, Balance, and Commissioning: Engineered Air Balance



Jackson Middle School Site Aerial



Campus Site Aerial

***Jackson Middle School
North East ISD***

2015 Bond Program Review for Jackson Middle School

- Relocate/Construct Main Football Field (Eastward) and All-Weather Surface Track
- Relocate/Construct New Rear Fire Lane and Athletic Parking
- Construct New Classroom Addition (7th and 8th Grade)
- Construct New Campus Central Plant (Air-Cooled Chillers)
- Construct New Field House with Restrooms and Storage
- Construct New Outdoor Basketball Courts (2 Total)
- Construct New Tennis Courts (4 Total)
- Construct Shot Put and Discus Pads

2015 Bond Program Review for Jackson Middle School

1. **Construct New 2-Story Classroom Addition (49,175 sq. ft.)**
 - a. 7th Grade Classrooms (14 per Grader-Level)
 - b. 8th Grade Classrooms (14 per Grade-Level)
 - c. Resource Room (1 per Grade Level)
 - d. Collaborative Learning Center (1 per Grade-Level)
 - e. Teacher Resource Area (Workroom, Conference Room, and Storage) – 1 per Grade-Level
 - f. Student Restrooms (1 Set per Floor)
 - g. Support Areas (IDF Room and Cart Storage Room) – per Floor
2. **Construct New Central Plant (Air Cooled Chillers, Boilers, & Pumps @ 4,550 sq. ft.)**
3. **Construct New Field House (Athletic Storage and Public Restrooms @ 975 sq. ft.)**
4. **Construct Various Site Improvements**
 - a. Relocate Main Football Field and Install Bleacher Seating
 - b. New All-Weather Surface Track
 - c. Outdoor Basketball Courts (2 Total) and Tennis Courts (4 Total)
 - d. Shot Put and Discus Throw Pads
 - e. Relocate Rear Fire Lane (also serves as Campus Bus Loop)
 - f. New Athletic Parking Area
 - g. Site Drainage Structure and Underground Storm Piping

Jackson Middle School Existing Conditions

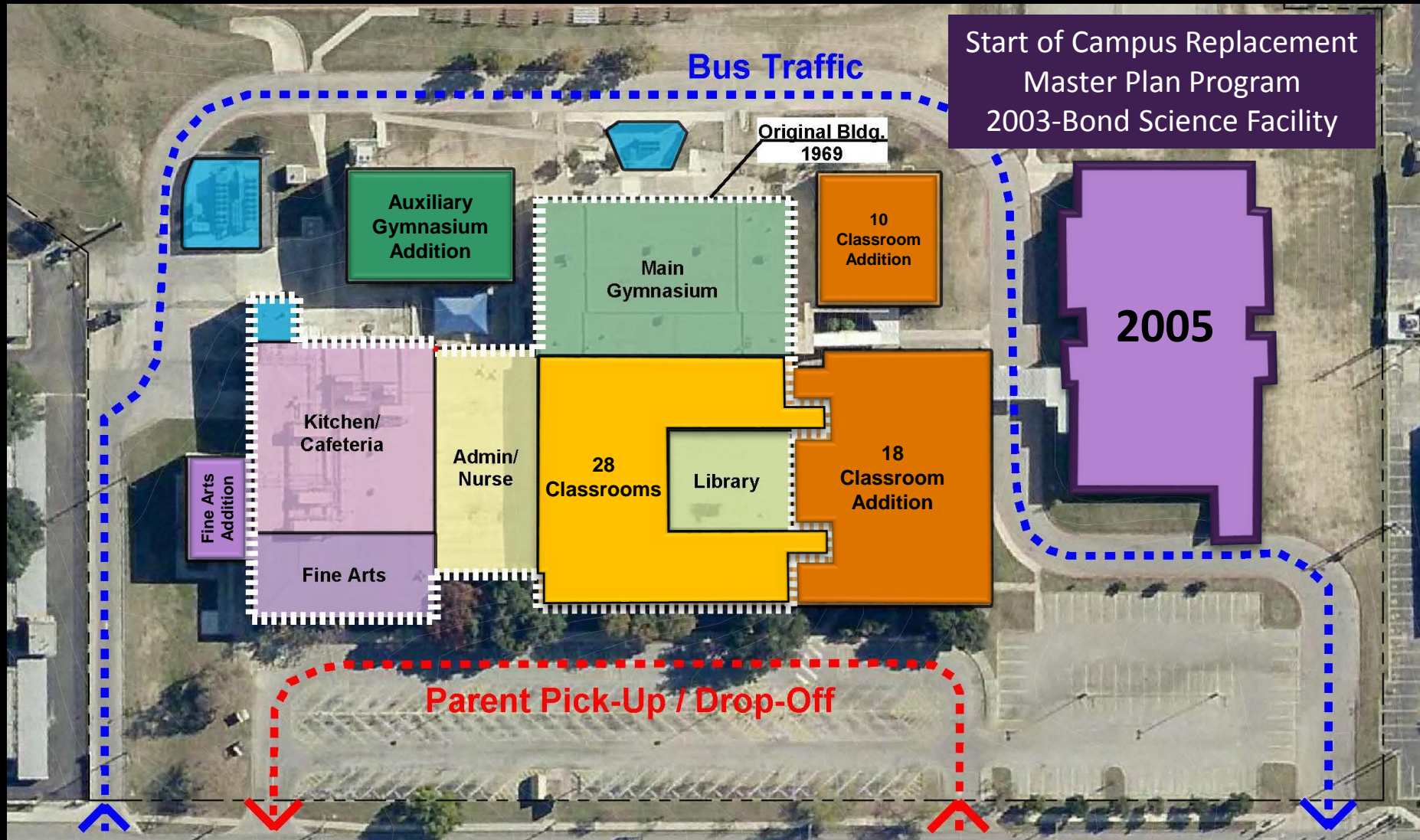

Existing Conditions

Jackson Middle School
North East ISD

Jackson Middle School Project Site Analysis

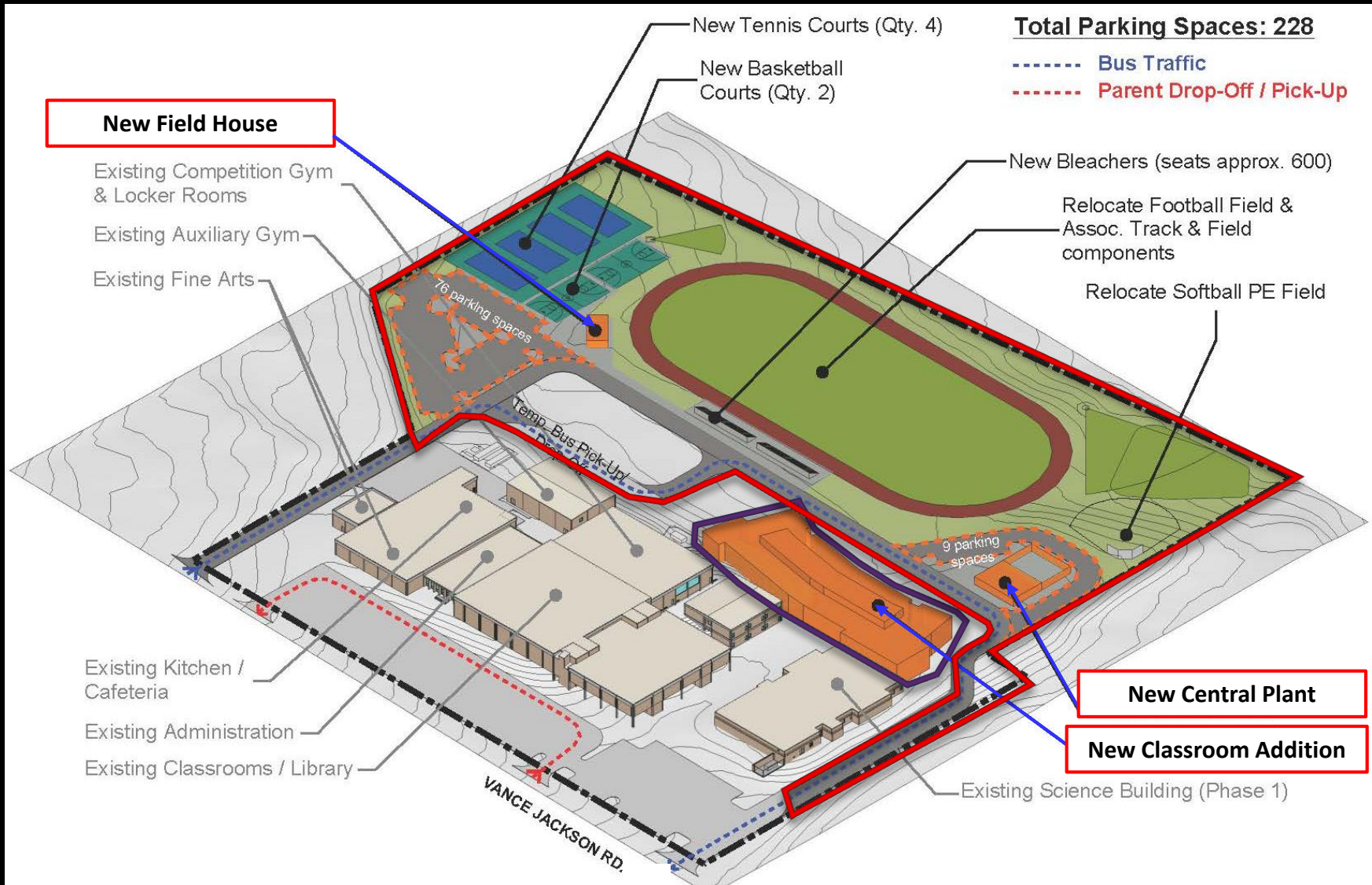

Jackson Middle School Project 1st Floor Plan

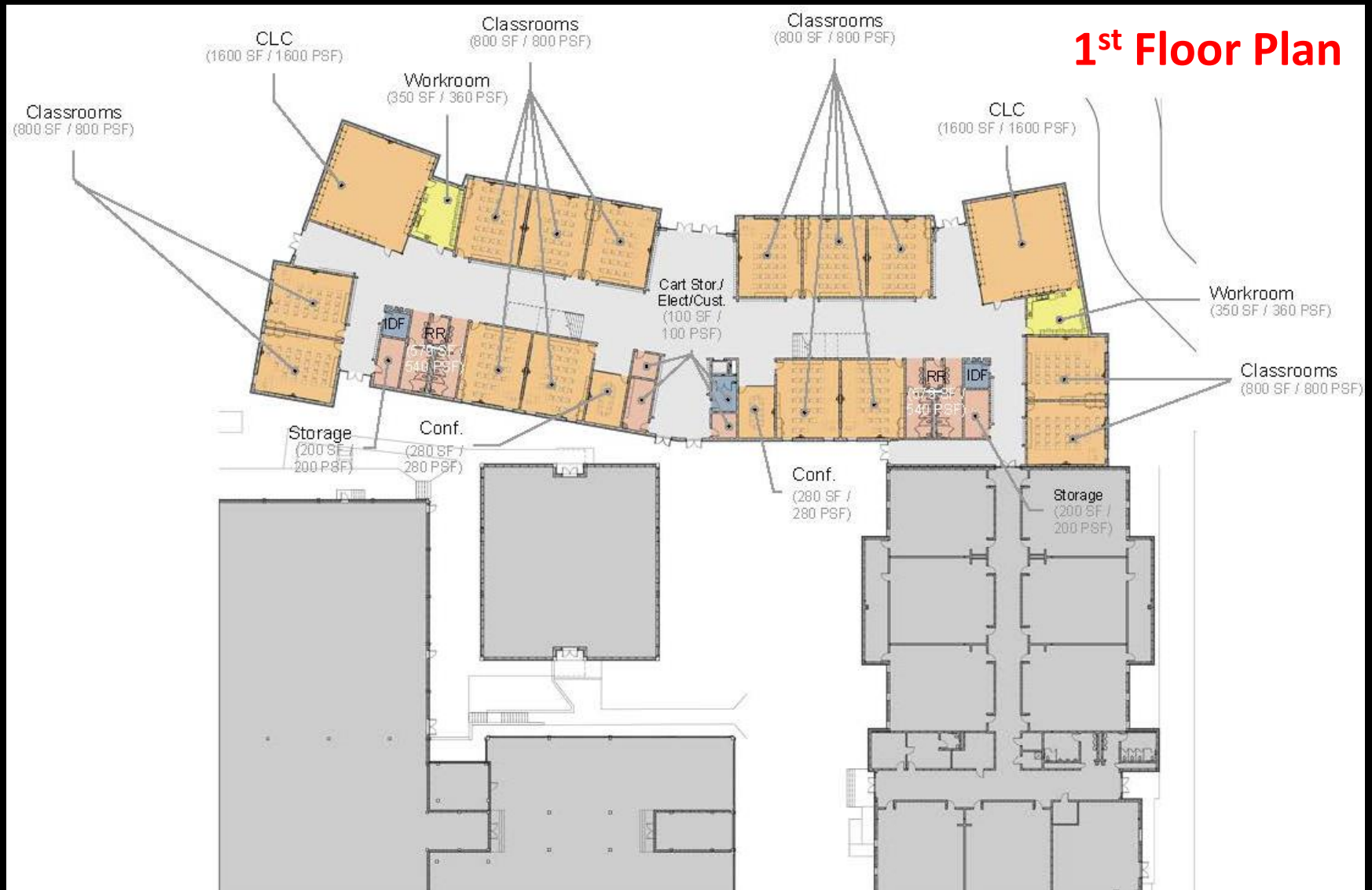

New Classroom Addition 1st Floor Plan

*Jackson Middle School
North East ISD*

Jackson Middle School Project 1st Floor Plan

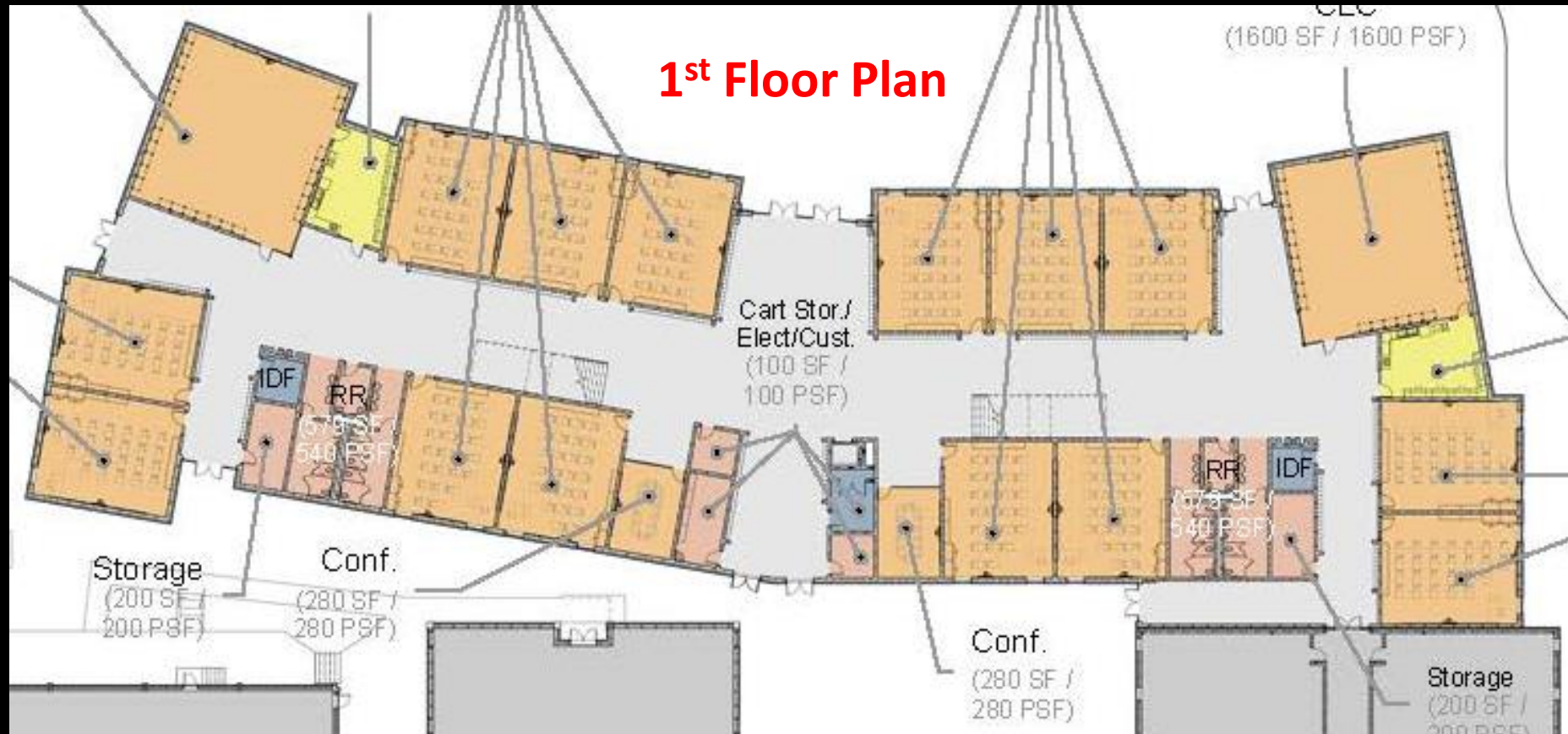

New Classroom Addition 1st Floor Plan

*Jackson Middle School
North East ISD*

Jackson Middle School Project 2nd Floor Plan

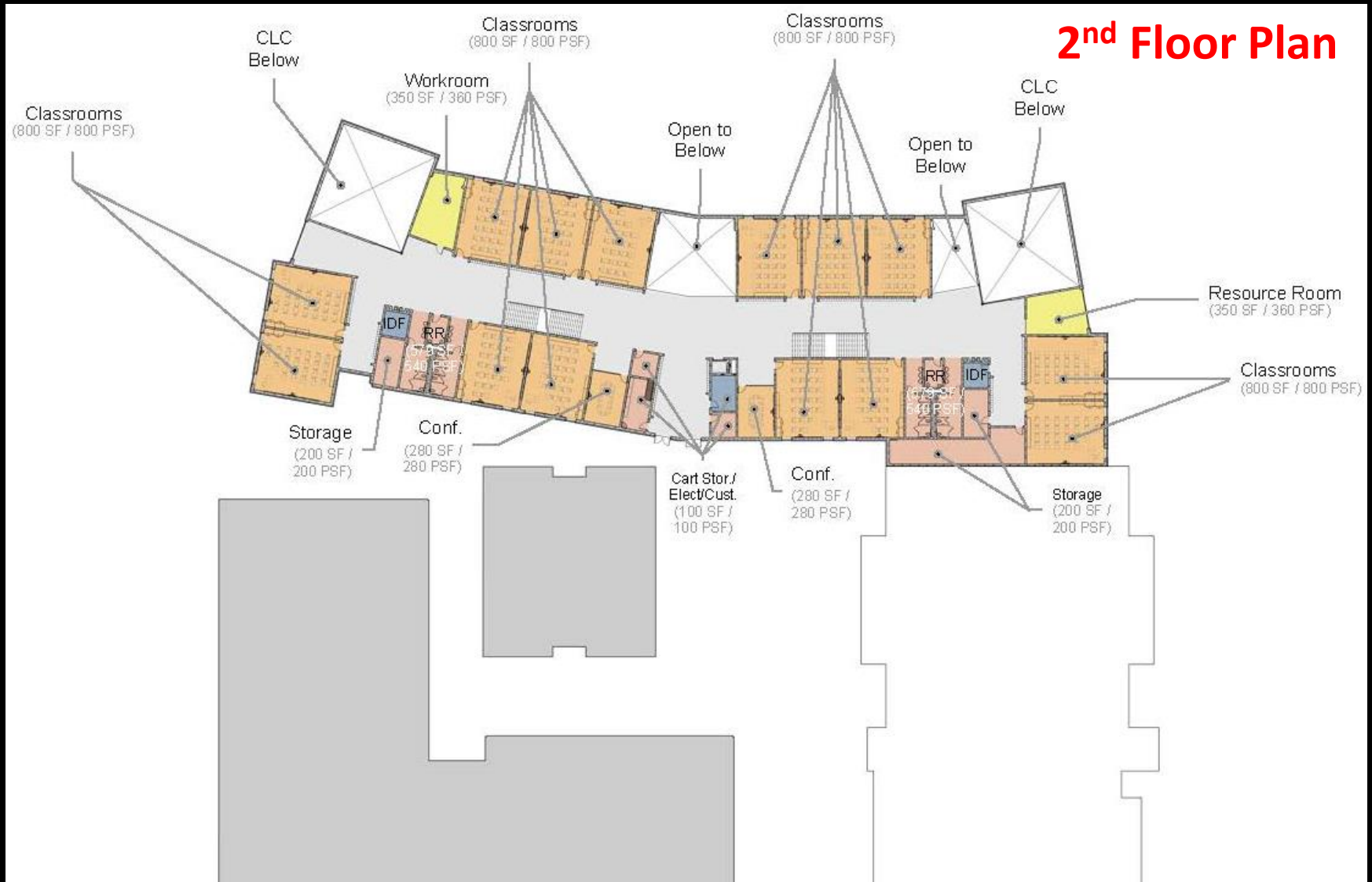

New Classroom Addition 2nd Floor Plan

*Jackson Middle School
North East ISD*

Jackson Middle School Project 2nd Floor Plan

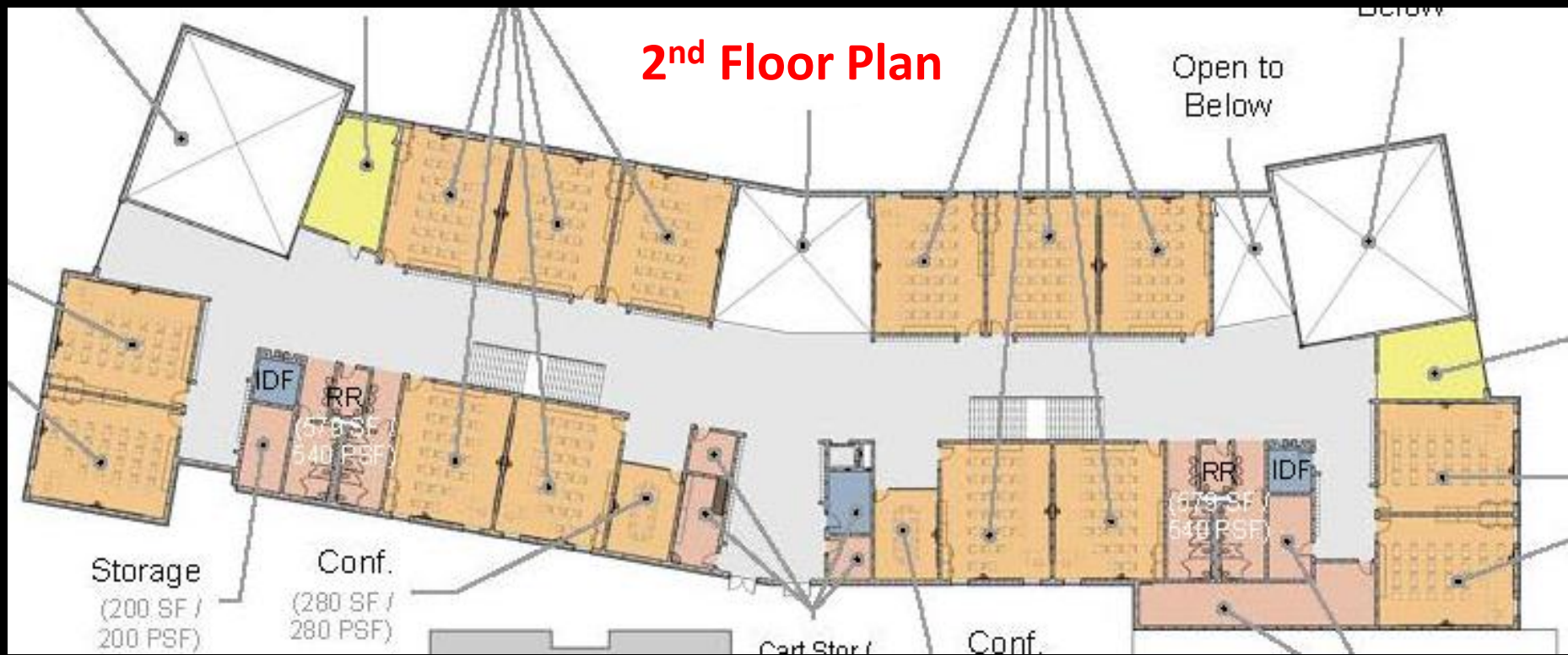

New Classroom Addition 2nd Floor Plan

*Jackson Middle School
North East ISD*

Jackson Middle School

New 2-Story Classroom Addition Perspective

View Looking West from Athletic Fields



2-Story Classroom Addition Perspective

*Jackson Middle School
North East ISD*

Jackson Middle School New 2-Story Classroom Addition Perspective

View Looking South West from Athletic Fields



2-Story Classroom Addition Perspective

*Jackson Middle School
North East ISD*

Jackson Middle School

New 2-Story Classroom Addition Perspective

Close-Up View Looking South West
from East Side of Building



2-Story Classroom Addition Perspective

*Jackson Middle School
North East ISD*

Jackson Middle School

New 2-Story Classroom Addition Perspective

View Looking East from Front Parking Lot



2-Story Classroom Addition Perspective

*Jackson Middle School
North East ISD*

2015 Bond Budget Review for Jackson Middle School

• Design Account:	\$ 2,500,000
• Construction Account:	\$ 24,500,000
• Technology Account:	\$ 250,000
• FF&E Account:	<u>\$ 750,000</u>
TOTAL BOND PROGRAM =	\$ 28,000,000

Jackson Middle School Existing Site Conditions

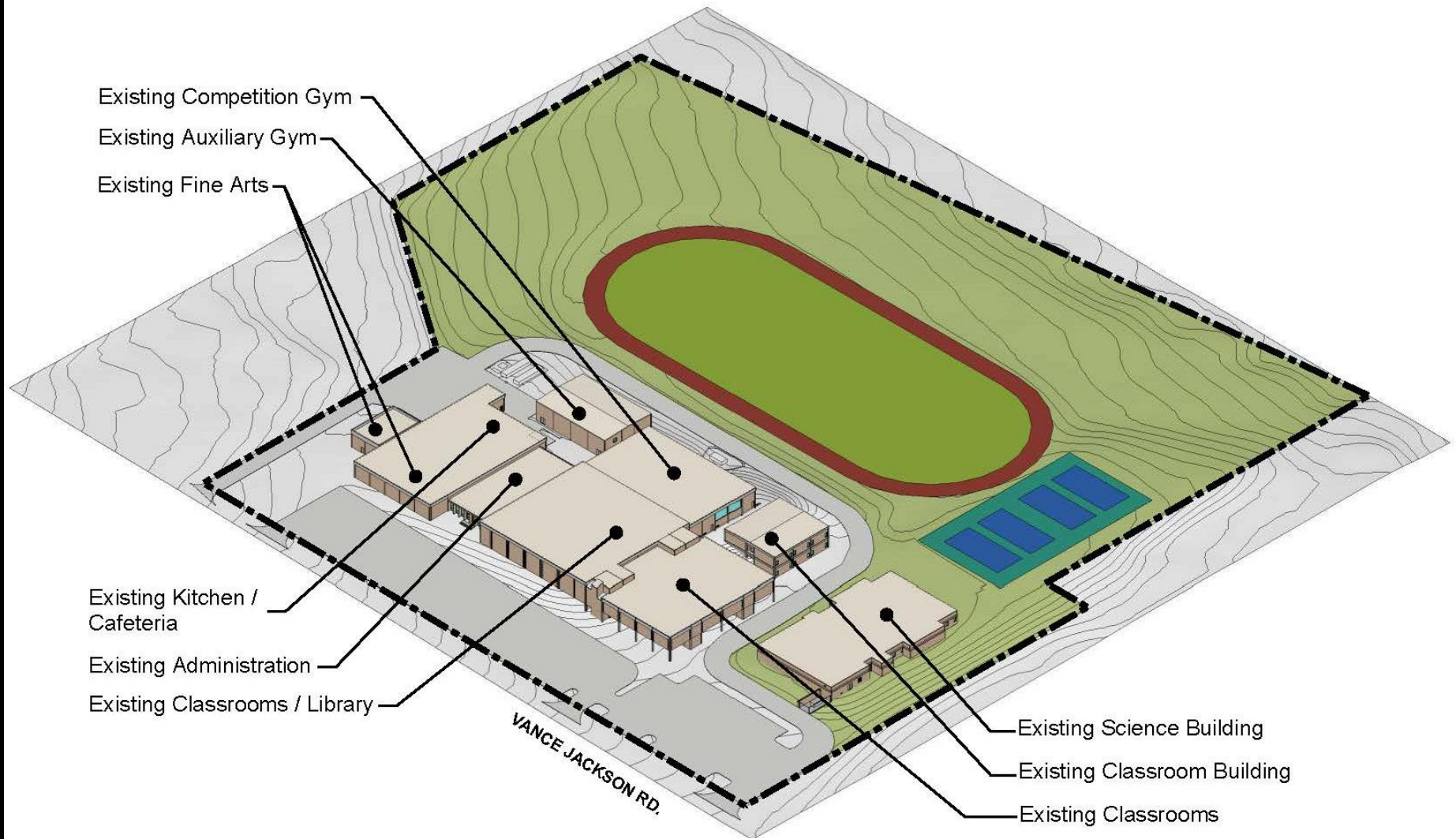

Existing Conditions

Jackson MS Project Construction Phasing Plan

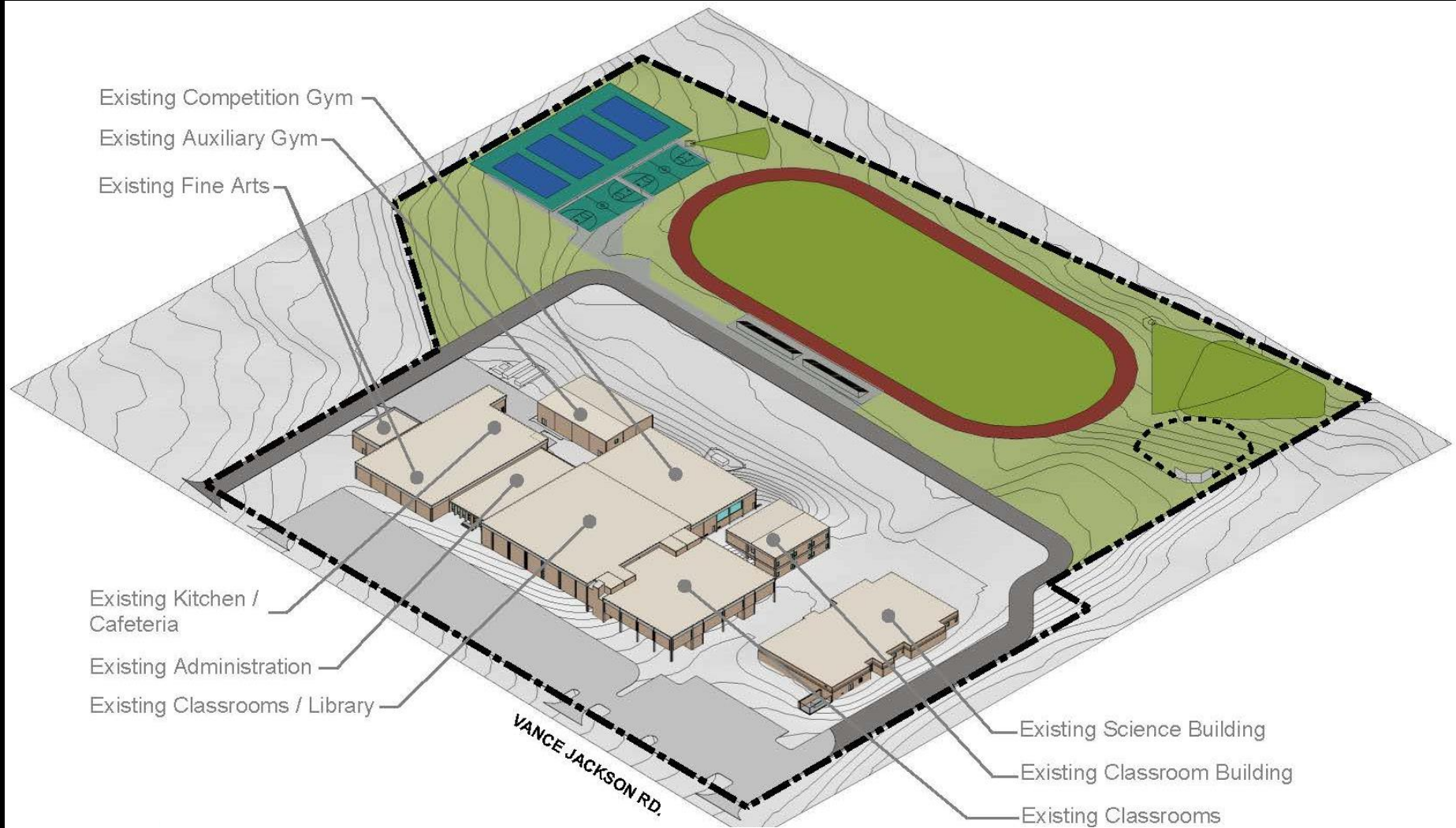

Phase 1 - Relocate Football Field/Track and Rear Fire Lane and Construct Basketball Courts, Tennis Courts, Shot Put and Discus Pads, and Campus Drainage Improvements (Nov 2017 – Nov 2018)

Jackson MS Project Construction Phasing Plan

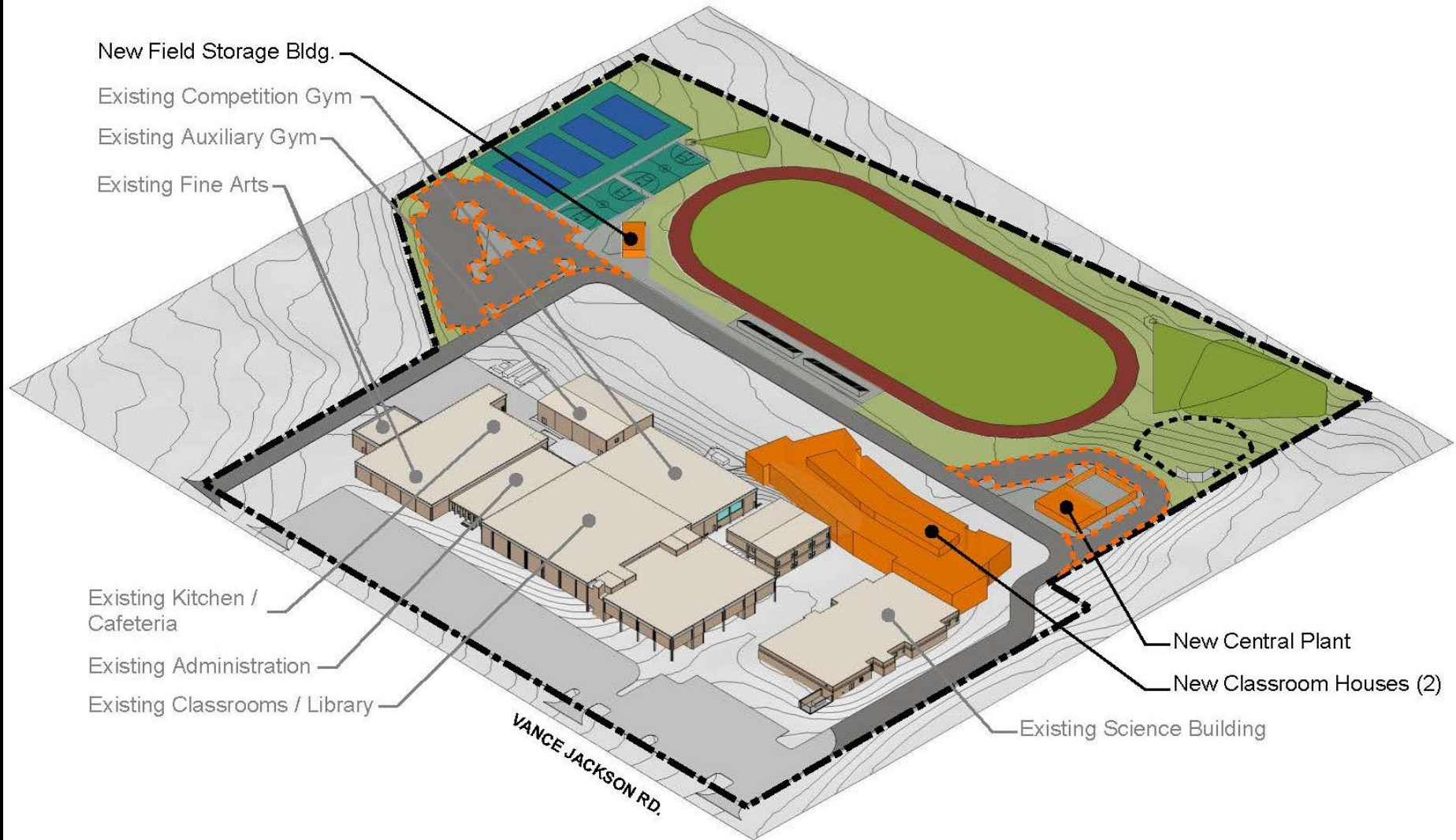

**Phase 2 – Construct New 2-Story Classroom Addition,
Central Plant, Field House, and Athletic Parking Lot (Feb 2018 – Aug 2019)**

Jackson MS Campus Site Conditions

2015 Bond Phase 2 Completion

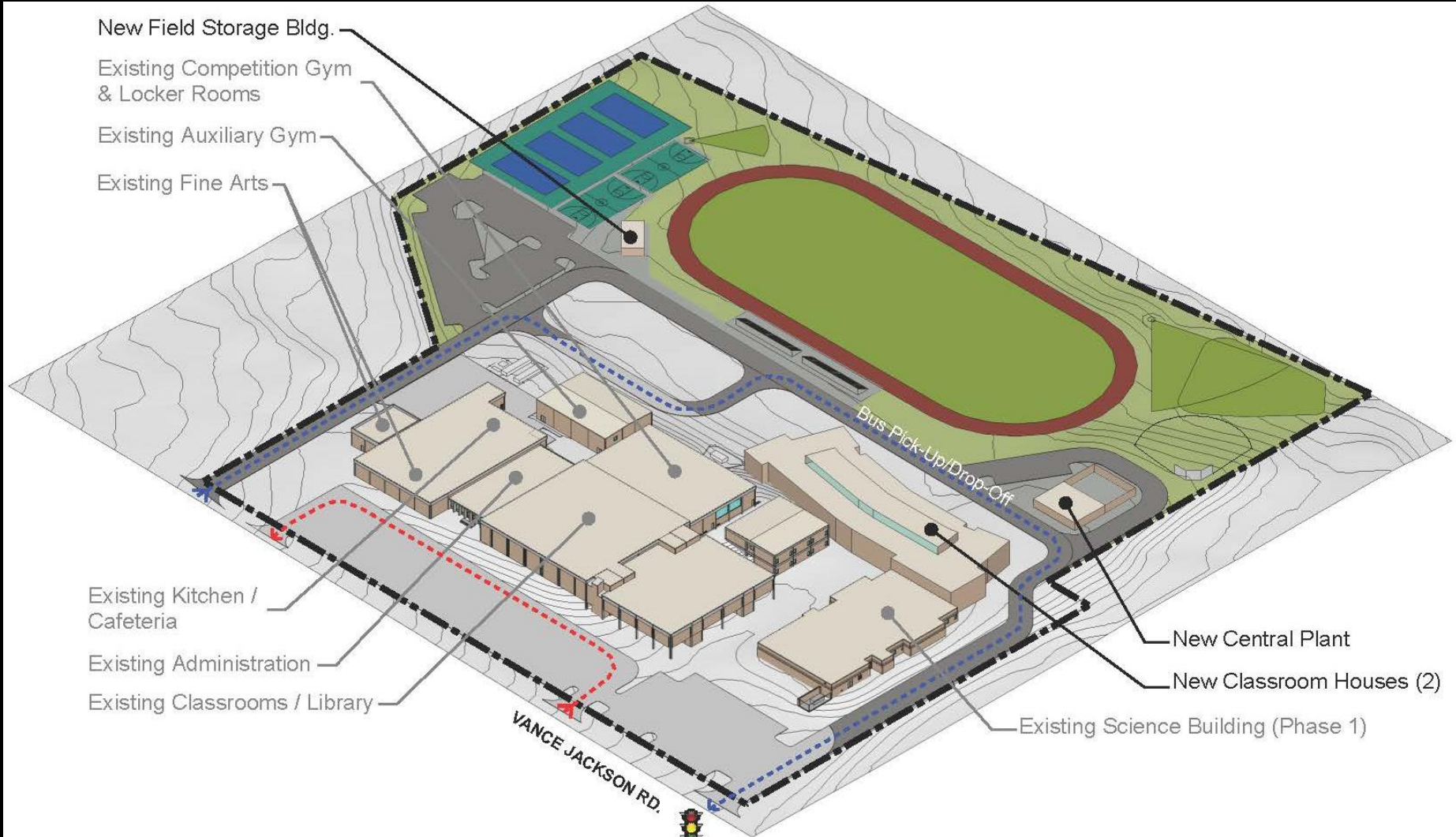

2015 Bond Phase 2 Project Complete (Aug 2019)

2015 Bond Design & Construction Timeline



Jackson MS Design & Construction Timeline

***Jackson Middle School
North East ISD***

Jackson Middle School 2015 Bond Project

District Staff Recommendation

- Recommend Approval of Jackson Middle School Schematic Design Presentation which Constructs the following 2015 Bond-Approved Program Elements:
 - Relocate/Construct Main Football Field (Eastward) and All-Weather Surface Track
 - Relocate/Construct New Rear Fire Lane and Athletic Parking
 - Construct New Classroom Addition (7th and 8th Grade)
 - Construct New Campus Central Plant (Air-Cooled Chillers)
 - Construct New Field House with Restrooms and Storage
 - Construct New Basketball Courts (2 Total), Tennis Courts (4 Total), and Shot Put & Discus Pads
 - Construction Budget = \$24,500,000



Jackson Middle School Phase 2 Campus Replacement Project Schematic Design Presentation 2015 Bond Program

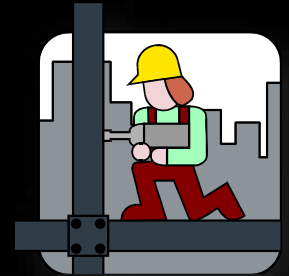
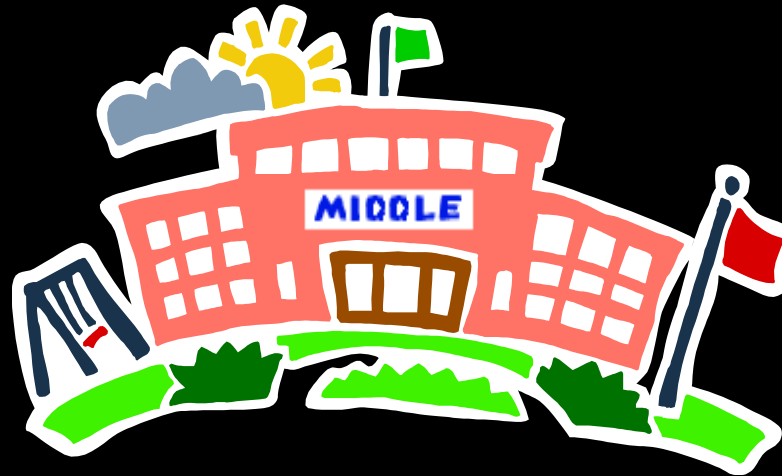

Questions